

WTM

WORKING TRIALS MONTHLY

May 2006

Volume 21 No. 2



JOHN ROBINSON
1945 - 2006

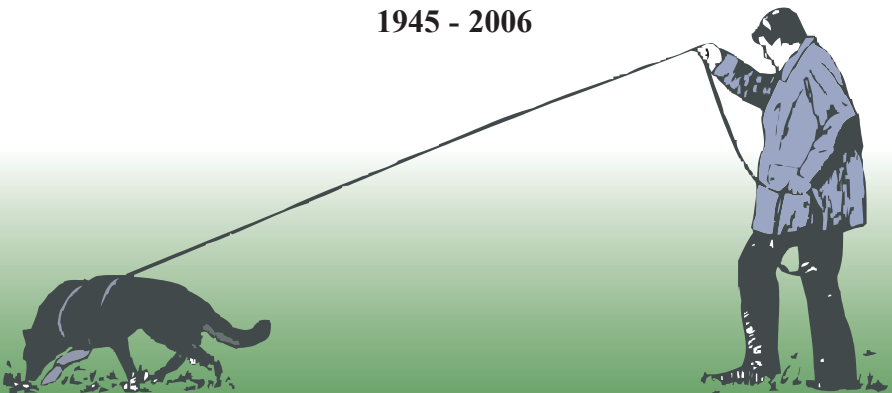

THE No.1 MAGAZINE FOR THE TRIALS ENTHUSIAST



WTM PUBLISHING

HOLLYBUSH FARM,
POUNDHURST ROAD,
RUCKINGE

KENT, TN26 2PQ

Tel.: +44 (0)1233 733322

e-mail: mark@workingtrialsmonthly.co.uk

Editor: Mark Skillin

Assistant Editor: Anne Bussey MSc

INDEX

- Page 3 Editorial
Page 4 Entries Closing
Page 4 Readers Letters
Page 6 Club Focus
Page 9 March Ticket Winners
Page 11 Tracking for Beginners Pt 3

WORKING TRIALS REPORTS

- 14 ASPADS CH
15 ICENI GSD Club CH
16 ASPADS CH
17 North East Counties WTS OP
19 North West WTS CH
21 B.A.G.S.D. OP
23 Poole & District DTS OP
25 ESSEX 2000 OP
26 Leamington DTC OP
28 Lincolnshire GSD ABTS CH
28 SATS CH
31 Hucknall And District OP
32 Scottish WTS OP
33 ICENI GSD Club OP

EDITORIAL

There were three championship trials in March. Congratulations go to Anne Thorpe and Glenalpine Izzie at Dalmain who were Rita Evan's TD winners at Yorkshire and to Dave Marchant and Waggerland Murphy who won the PD Ticket at Lincolnshire under judge Roy Williams. John West judged the TD at SATS which was won by Judy Meekings and Withylinch Murr at Windlebrook (first time in ticket!) Well done all and good luck at KCC's 2006.

Thanks to everyone who responded to the list of outstanding 2005 trial reports. There are still a few left and I will print them as soon as they arrive.

Over the past few months I have been reminded that this sport of ours mainly consists of mature adults and not so many spring chickens. With this in mind I have increased the type size to aid readability. Your comments would be greatly appreciated.

Please, remember the weather is warming up now - dogs die in hot cars.

MARK SKILLIN

Editor

The opinions expressed within this magazine are not necessarily those of the Editorial staff. Written permission must be obtained for any item to be reproduced whether in newsletters or on the Internet. ©

READERS LETTERS

Dear All,

I wish I had more or better words to say other than thanks. Thanks just seems so inadequate to express the gratitude that I feel for all the support and kindness, that my family and I have received from the Working Trials community.

I would especially like to thank all those who attended John's funeral, many of whom travelled from very considerable distances, and also all who sent their support via the extraordinary number of condolence cards that we received.

Special thanks to everyone for the donations which amounted to around £1000.00. Haywood House Hospice will verify the exact amount next week. This money will contribute to the continuation of the exceptional work offered by this hospice, without whose care we would simply not have coped.

I would particularly like to thank my very special friends Jan & Tom Darby who were there 24/7 from the day of diagnosis to the very end. Thanks for everything Jan & Tom.

Also need to mention Jan & Jim Sewell & Rod and Polly all of whom were always there for me, as well as Andy & Liza Fox who were always prepared to look after the dogs when necessary.

With sincere thanks and gratitude to all the Working Trials Community.

MARGARET ROBINSON & FAMILY.

THE THOUGHTS OF A WORKING TRIALS COMPETITOR:

In this time of constant changes to Working Trial Regulations, code of practice for judges, stewards, seminars by a Kennel Club Accredited Trainer, examination on the requirements of a Working Trial Judge, I have not seen or come across a code of practice for the Working Trials competitor. (The Kennel Club has a code of practice for the dog trainer 2/94). Experienced trialists know the procedures of behaviour at a trial but our up and coming trialists learn by their mistakes. Maybe we should have a code of practice for the new competitor included in the Working Trials Regulations booklet e.g.

1 Read the up to date rules before you set off for a trial.

DON'T FORGET ENTRIES CLOSING

May

23rd	Scottish Working Trials Society (Ballater, 23rd - 25th June 2006)	OP	TD WD UD CD
26th	Wessex WTC (Uptontery, 3rd - 9th July 2006)	OP	TD UD CD

June

7th	North East Counties WTS (Satley, 7th - 9th July 2006)	OP	PD UD CD
-----	--	----	----------

ENTRIES MUST BE RECEIVED BY THESE DATES

NATIONAL DOG TATTOO REGISTER

The NDTR has been providing an invaluable service to the dog breeding and dog owning public for almost twenty years. The tattoo and registration is the only method of ID to date that cannot move, be removed or altered. The tattoo and registration has numerous advantages over other forms of ID. It is a known theft deterrent, it is visible and readable, and can ensure a rapid response in the return of dog to owner.

WORKING DOGS ARE VALUABLE, DON'T TAKE RISKS.....

USE THE TATTOO, YOU KNOW IT MAKES SENSE!

ALL ENQUIRIES TO:

**NDTR
PO Box 5720
Harwich
Essex
CO12 3SY**

**Phone: 01255 552455
Fax: 01255 552412
Email: tattoo@dog-register.co.uk
Web Site: www.dog-register.co.uk**



WORKING TRIALS AT CRUFTS

2 Report to the base as soon as you arrive.

3 If your nosework is scheduled for the afternoon, try to work your stays and control in the morning.

4 Please remember dog, lead, dumb-bell and poo bag when going on to a control field.

5 Your catalogue number really is important, do remember it.

6 Listen carefully to instructions from the steward and judge during your round, stays, nosework etc.

7 A thank you to judge, stewards, base, kitchen staff is always appreciated even if you have failed.

8 Inform base/trials manager if you decide to scratch and go home - so that they can let the appropriate judge know you will not be working.

To most of us this is what we know and do but competition nerves, arriving late due to traffic, cannot find base etc all play a part in forgetting some of the above especially when you are just starting out on our wonderful hobby.

What do you think out there? I am sure there are lots more do's and don'ts. Please feel free to add to the list.

SUZANNE PLUMB

THANK YOU

I would like to thank everyone for the cards, phone calls and congratulations I received following Murphy's ticket win at Yorkshire. They help to make a special day even more memorable. Thank you all.

DAVE MARCHANT

A while ago, I mentioned to Barry Harvey that it was about time there was a decent breed representing Working Trials at Crufts and this year there was - he asked me if Busby and I would join the team!

Although I had visited the Working Trials stand in previous years, I had never seen one of the demonstrations, so I had no idea what we were in for, not that a detail like that would deter me, after all, I did not really know what Trials involved when I started! The theme this year was the history of Trials. Stan Ford (when he could spare the time from his high powered lunches!) was commentator and explained to the audience (and we really did have crowds watching) that trials had started eighty years ago as civilian tests for GSD's. Mary Cooper and her lovely lad Boss were there to represent the breed. Stan went on to explain how other breeds had become involved, as Judy Meekings went into the ring with her Labradors, Megan and Brig. Then Jean Howells and Jed were introduced as the Border Collie being the next breed to enter Working Trials. Last, but not least, Busby and I entered the ring as an example of all the other breeds that could have a go (the words 'loony fringe' were not mentioned, but I felt them hovering!)

Barry Gilbert and Lowrie made up the team, and between the lot of us we went through most of the trials exercises showing how they are trained and as much as we could of the finished product within the limitations of the Dog Days Out ring.

All of the dogs worked extremely well considering the unbelievable level of distractions. The demo started with Judy and Brig doing training for the retrieve. Busby then

showed how the complete exercise is done with a dumbbell and Lowrie impressed us all with his article retrieves, particularly the hold on a piece of chalk with not one piece broken in the whole four days! Jean's Jed and Judy's Megan then did searches in the heaps of brushwood at the side of the ring, with the dogs working only inches away from the audience. Jed, Brig, Megan and Lowrie all contributed to the demonstrations of the speak which was followed by the sendaway and, I must say that Barry's sendaways and redirects with Lowrie in the confines of that small ring were very impressive. Stays were demonstrated while we erected the jumps and Jean and Jed did heelwork around the dogs, all of whom were rock solid. It was a wonderful opportunity for me to show how controllable and good natured Staffords can be even when there is a Border Collie nearly treading on them! The demonstrations finished with the jumps. Busby went first, and although we did not do his full size jumps on the hard surface, he still managed to impress the crowd and was well applauded for his efforts. In fact, he ended up so excited by the whole thing that I have completely lost any control around the jumps! Never mind, it's another training opportunity! Mary then did the jumps with Boss, showing how the height is added gradually in training. Then the Labradors and Collies showed that they could do them, too! All of the dogs did a jump as they left the ring - except Boss on the last demo, he decided he'd had enough so Mary actually did the clear, while Boss trotted round the side much to the delight of the audience. All of the dogs were very well behaved outside the ring, too, with a constant stream of people wanting to meet them. There was a lovely moment when Jed was lying on the floor with his head in the lap of an adoring young boy totally oblivious to the noise and crowds around them.

We were absolutely worn out by the end of

the four days, but what a fantastic time we had! The support from working trials people was brilliant, so many came to see us and watch the demos. The other teams on the Dog Days Out stand were so friendly, too, several of the Bloodhound group had been involved in the tracking match a month earlier and all of them remembered Busby! The team leader for Obedience had met us before and asked Busby to join in their demos as well, in fact, he ended up being a bit of a star and seemed to have a constant circle of admirers. It was fantastic to be able to do so much positive P.R. for Staffords as well as promoting Working Trials.

MARNEY WELLS

P.S. And if anyone thinks that doing demos at Crufts ruins your training, have a word with Judy, she and Megan won the ticket at SATS the following week!! Congratulations, Judy!

WESSEX WORKING TRIALS CLUB

Sunday March 19th found a group of 21 WT people collected in the village hall at Upottery, from as far afield as Cornwall to the west and Hampshire to the east.

Sitting attentively at tables with note pads and pencils at the ready listening to the speaker for the day - Sue Jones (herself a tri-alist, she therefore understood our particular needs) - and the subject? No not dogs, but the Basic Food Hygiene course! with a certificate to be hopefully gained by the end of the day. This certificate is valid for 3 years.

With new Food Safety Regulations in January 2006 - stating that 'food business' means any undertaking, whether carried on for profit or not and whether public or pri-

vate, which includes the preparation, packing, storing transportation, distribution, handling or offering for sale or supply, of food. The Food Standards Agency clarifies the situation by stating:- if you are preparing any food as part of a business, or on a voluntary basis for a charitable or community event, you must follow food safety regulations.

The onus of responsibility is placed on the event organisers to ensure that all helpers in the kitchen have an awareness of food hygiene. This would seem to indicate that at this time it is advisable for at least one person working in the kitchen to have the 'Basic Food Hygiene Certificate'

The course started sharp at 0930hrs, as the day's programme was very full, culminating in a multi choice test paper based on what we would learn during the day.

Sue had handouts for each person, with the day's programme on the front page divided up into sections, a booklet which highlighted salient points in an easy to understand fashion, and the Chartered Institute of Environmental Health Book, Food Safety First Principles.

The course covers a wide range of subjects from: What is food poisoning? to pest controls, via how our food is contaminated, growth requirements of bacteria, common food poisoning bacteria, food hygiene legislation, how to avoid cross-contamination, case study exercise, and cleaning and disinfection.

Sue started the course by going round the table and asking each person if they had ever had food poisoning, with widely varying answers, the question was thoroughly explored, with all pertinent details examined, exact symptoms, and from there nam-

ing the most likely bacteria to have caused each episode, and the foods most commonly responsible for that particular bacteria - this stopped most of us from feeling hungry for quite some while!

We were divided into threes for some exercises, and had to work together to provide answers, which Sue then went through with us, and supplied any that we hadn't thought of.

A quick coffee break half way through the morning and back to work until lunchtime, when some people went to the pub. Some of us had brought our own lunch with us, and took the opportunity to get out in the sunshine and rest our (in some cases over-worked) brains.

Back from lunch and down to work again, afternoon tea was taken whilst working, case studies in our threes again, with us hopefully finding the answers to the problems. A quick round the table quiz, and time for the dreaded test.

The test is a straightforward tick box multi choice paper, with a total of 30 questions of which you must answer 20 correctly - you have 1 hour in which to complete the paper, this is ample time. If you have listened and worked throughout the day, the answers are all there; as with any questions you must read them carefully.

The really nice thing about the test was that Sue was able to check each one immediately and tell us if we had passed - YES - everyone had - Thanks to Sue's hard work and expertise throughout the day it seemed almost easy!

Thank you Sue for your knowledge and patience with a group of very non catering people. Hopefully our trials food will now be even better, and more importantly SAFER.

MARGERY LEE

MARCH TICKET WINNERS



**YORKSHIRE TD WINNERS
ANNE THORPE AND
GLENALPINE IZZIE AT DALMAIN**

**LINCOLNSHIRE PD WINNERS
DAVE MARCHANT AND
WAGGERLAND MURPHY**



**SATS TD WINNERS
JUDY MEEKINGS AND
WITHYLINCH MURR AT WINDLEBROOK
WITH JUDGE JOHN WEST**

GEOFF MAYES
and
RUNFOLD TEMPEST OF OBERAN
CDex UDex WDex TDex

Geoff is Betty Mayes' significant other half. At SATS Championship trial under the watchful eye of judge John West. Geoff and Storm finally gained their first TDex. 78 years young and still tracking on the Ashdown Forest.

Geoff - You are an inspiration to us all.
Well Done.



CANINE BIATHLON 2006

9th July 2006 will see the eleventh national canine biathlon.

Last year this event attracted thirty-six competitors from all parts of the country and raised a total of £5200 for charity, the main beneficiaries being the East Anglian Air Ambulance and Dogs for the Disabled.

This year the two main charities will be the NSPCC and Dogs for the Disabled.

The event covers a distance of 4900 m and involves twenty-two tests which challenge both dog and handler. For the first time, we may see entries from the Continent

This event is the only competition which combines elements of working trials, agility and obedience as well as testing the handlers.

Entries close 30th June

Further details and entry forms, apply Chris Farrer, St Mary's House, Bungay, Suffolk,
NR35 1AQ
Tel: 01986 892444

TRACKING FOR BEGINNERS - PART 3

Bits about Tracking Training that Experienced people will already know.

by Rod Roberts

Surfaces and Corners

However even and perfect a field looks, there are likely to be good bits, bad bits, wet bits, dry bits, areas where the animals have been extra active. In truth it is rare to have a field that is truly even. On arable, tractors have to turn, seed drills miss, maybe the shape of a wood at the side of the field has caused wind burn.

When we are talking about training the dog on different surfaces we are not only meaning grass - grazed or silage, plough - rough or rolled, stubble - grown through or sterile. (I don't know whether that's the right term, but it's ground where the crop has been weed-killed to death.)

Sounds complex, but what it's all about is your observational skills. When you are laying training tracks there are very few constraints; you come to a bare patch you stop short - nobody in their right mind walks through standing water, do they?

Well the answer to that is, in training you don't have to. But the tracklayer at a trial will have to work to a pattern, and while most judges build into their patterns room for small adjustments, the pattern still needs to be adhered to. So at a trial, you could be tracking along happily when you come to an area of standing water, or ground where the cattle have been standing a few days before. You can deal with this in three ways: - you can fail the track by pulling the dog off; you can let the dog work and lose the track because the dog hasn't the skill to cope; or you can prepare your dog for changing surfaces before you start trialling.

In the first two cases, the option then is to

go to the judge and moan about the ground. If you do this forcibly enough, you will probably be informed that it's the luck of the draw, or that all the fields are the same. This will have another hidden effect; you will have gained a name for being a bad loser, and you certainly will not get another track; asking for one will only cause the judge some mirth.

It follows that the best option is to prepare your dog for changing surfaces before you start trialling.

Get to know your training fields! It seems obvious, but there will be patches where you have game tracks; areas round cattle troughs where the stock have cut it up badly; low lying areas which will go boggy after a shower or two. When you are looking at fields, you'll notice changes in the colour and texture of the grass - this usually gives a warning of changing ground conditions beneath the grass. When the cattle are out of the fields, gates will be left open; make all these features part of your training tracks. If you are lucky enough to have some arable to train on, cross on to the grass margins around the edges of the fields. A good way to familiarize your dog with different surfaces is to do reverse order tracking (see last article). If your long straight legs go across bad areas, scrub your feet as you lay the track over the bad ground, then place an article/food pot a few paces the other side, so the dog is rewarded for working through the problem.

When you first start tracking on crop, i.e.; ~ wheat, barley, or even reseeded grass,

you will notice the crop has a grain (the line where the seed drill set the crop). Round the edges of the field will be what is called the headland; the grain here will follow the hedges. In this area the crop will often be thicker and denser than in the open field. This is because the tractor, when sowing the crop, had to turn at each end. When the bulk of the field has been sown, the tractor will have gone round the edge to seed over its turning areas. The extra growth is caused by the double seeding.

With this in mind, do your first few crop tracks along the grain of the crop. The dog will convert to this very easily, and tracking directly across the crop will only be marginally more difficult.

The real difficulty with crop comes when tracking diagonally across the corn, which will cause the dog to saw tooth (track in small zigzags). This will be wrist slashing time again. Your good tracking dog, that's coming on well, will suddenly be all over the place, difficult to read and really disappointing - don't worry; it's just part of the process of learning. It's absolutely imperative that you put the dog in a position where it can learn how to cope with this. Imagine you are looking along the grain of the crop; turn to a right angle; you are now looking directly across the grain. If you turn back 15 degrees, you will have a slight diagonal, which the dog should manage. By laying 3 reverse order tracks, which go from 15 degrees to 45 degrees, the oldest being 45 degrees, the reduced scent as the tracks get older will help the dog to sort it out. Continue practising till the dog is comfortable and confident tracking just a few degrees away from parallel to the corn. Treat the headland as you would a different surface on a normal track. The extra growth will take away any difference caused by the changing grain. It's a good

idea to do as much diagonal work as practical.

Corners

In a dog's perception, a corner is the loss and relocation of a straight leg.

There's no reason why you can't train corners with the dog while it's gaining experience on changing surfaces. But beware. Make sure you do your corners on consistent ground - change only one thing at once.

By now you will have done many dozen tracking sessions. Most of the issues caused by motivation, stamina, concentration and focus will have been addressed, and although you have only done straight legs, the skills your dog has learned will be matched by your understanding and rapport with the dog, because you have been working together for many, many hours. You should be well on the way to becoming a team. (Hopefully, fingers-crossed.)

You are now ready to learn to do corners. For the first few sessions on corners, the ideal way is to have a field of lush grass. If you can see the track clearly, it will allow you to keep your concentration fully on the dog, and still know exactly where the track is. Even for a very good and experienced track layer there is a small amount of distraction locating the track.

When we were doing all the work getting the dog accustomed to tracking off the wind we were in fact preparing for this day. As you look at the field where you are going to work, it might be worth doing a short straight leg across the wind just to settle the dog in.

Ideally the first leg leading to the first corner should be slightly down-wind of across wind. Make the first leg a minimum of 60 paces. When you lay your corner, walk into it on a normal stride, stick a pole in at the point of turn, walk out 15 paces into the wind, about turn, walk back to the pole

using the foot prints you can see, take out your marker pole, about-turn, walk along your track. When you reach the end of your triple laying, keep going for the next 25 paces. Place your article/food-pot and walk back round to the start. You are going to track immediately.

Handling your first corner.

Start the dog tracking in the normal way, and as you approach the corner, move up the line till your hand is about 3 feet from the clip of the tracking line. If the corner is to the left, you will want your right hand on the line; because the dog has done large numbers of straight lines, it is likely to try to overshoot, on the assumption that the track goes straight on. As the dog passes the corner, step to its side, and excitedly point at the new direction of the track. When the dog takes it, give background praise to confirm to the dog that it's right, without breaking its concentration. Make a big fuss when the dog gets the article. If you can praise and reward the dog in a meaningful manner without getting it too excited, it will be in a better state to concentrate on the next track.

Around now someone usually says "My dog pulls so hard, I can't handle him with one hand", or "My dog is so sensitive, if I handle it like that it'll never track again". The answer is simple - "Flyball". Just do it, adapt your handling to suit your dog and get on with it. (Said he impatiently.)

Over the next few sessions, do as many right turns as you do left turns, and gradually rotate the tracks in relation to the wind. In answer to the question, "Shall I do right one day and left on another, or shall I mix them?" - it doesn't matter. Mixing them will save you a lot of walking.

When the dog is changing direction almost seamlessly, it is time to ask a bit more from

him. This will require changing the handling. You are now at the point where the dog is changing direction well, often tracking round the corners, at other times it might seem to be a bit handler reliant. To get over this, lay your track with the second leg downwind. Instead of triple laying or scrubbing out of the corner, come out on a normal stride. Place your article/food pot as normal. In an instant, you've created a far more difficult corner. The likelihood is that the dog will get to the corner and look to the handler for help. Don't give it any. Stand quietly facing in the direction of the first leg, and gently encourage the dog to find the track. If the dog starts to move in a circle, gently encourage and allow the angle of your body to follow the dog. When he recognizes the track, give background encouragement and follow the dog. From now on, I would only show the dog in cases where it is really struggling.

Note that the handling when you reach a corner is really important. When the dog's head comes up, stand still. Don't face the next leg as the dog circles looking for the track, keep facing him; shuffle your feet round without stepping away from your position. Don't pass the line over your head (to do that you'll have your back to the dog - not helpful). When the dog locates the next leg, allow him to take some line, to show you he is committed, and then follow him.

You now have a dog which will do 3 straight legs, 400 paces long, (1200 paces) sometimes as much as 2 hours old. It has learned to cope with cross winds and changing surfaces. It has learned to do corners. This could be pretty well described as a tracking dog. But????

Next month: Motivation, Experience, and Articles.

WORKING TRIALS REPORTS

ASPADS CHAMPIONSHIP TRIAL

21st - 24th July 2005
Rutland, Greetham

STAKE: UD

Judge **SUZANNE PLUMB**
Stewards: **Jane Gray (search) & Lorna Cottier (control & agility)**
Tracklayers: **Ruth Payton & Sue Ashby**

Thanks to ASPADS for the invitation to judge the UD stake, I thoroughly enjoyed myself over the two days. Thank you Jacqui and your team for running such a well organised trial, thanks also to Dorothy and John in the kitchen for their hard work keeping us fed.

Expecting the weather to be hot I took the usual shorts, sun cream etc but it was dull and cool which was more suitable for the dogs as tracking was on short, dry grass. My two tracklayers Ruth and Sue did an excellent job laying the track pattern in fields that were different shapes and sizes giving each team an equal chance of getting round, thank you girls. The track pattern, although straight forward, tested the handlers but most teams got round - sometimes the dog does know best. Special thanks go to Jane my search square steward, no failures and such good company too.

Control and agility followed and I was ably assisted by Lorna. She put all the competitors at ease guiding them around the long grass field. We saw excellent

sendaways with some teams getting full marks but heelwork and retrieve were not so good, maybe it was the long grass? Jumps were well done with only two teams failing and no failures for the down stay. Thank you to the handlers that informed me that they were not putting their dogs in the stay.

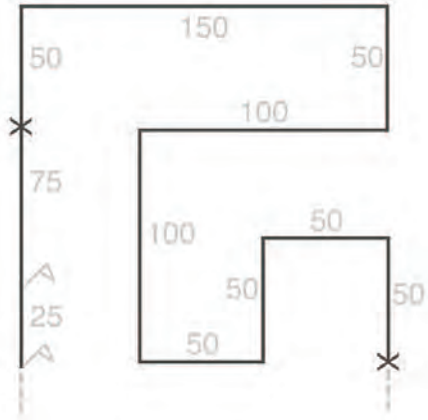

Now to the qualifiers:

1st Mr D Shearer and DREAGANTA DONN (BC) 195 pts. Well handled by Doug, Donn seemed to hit a brick wall on one corner of the track but with your help found the leg and didn't put a paw wrong from then on. Losing only 1 on the C & A brilliant, a pleasure to judge you, congratulations on your win.

2nd Mr A Fox and DAZLEROCK'S BRYN N SCOOBY TOO (BC) 188 pts. An excellent track followed by 4 out of the square in 2 minutes. Bryn decided he didn't like the gun noise but I am sure it was the echo he spooked at and in Andy's experienced hands it won't become a problem.

**ICENI GSD CLUB
CHAMPIONSHIP TRIAL**

Well done.

3rd Mr J Watts and JAYESS ROUGH N TUMBLE (GSD) 186 pts. Again another excellent track gaining 88.5 marks and 4 out of the square. Timba gave us a scare on the scale but his attitude and John's careful handling got him over. Well done on 3rd place.

4th Mr K Johnson and DUNNSLAYNE BLUE SKIES (WSD) 180.5 pts. Nervous handler but Sky can track. Lovely control, I am sure you will make the top stake in the not too distant future. Good luck.

Also qualifying UDEX.

Ms K Peyton and GLENALPINE SOLOMON (BC) 180 pts.

Mrs S Shearer and DREAGANTA DEODUBH (BC) 179 pts.

Mrs J Stamp and RESERVOIR RESCUE (XB) 178.5 pts.

Mrs R Cahill and BAYRIVER AMBUSH OF SALENZE (GSD) 177.5 pts.

Mr I Bradley and HOEGRANGE ZEUS (Lab) 172 pts.

The above team was a delight to judge, their attitude to our sport was wonderful.

Miss K Woolley and TYNSIL TIGER WALKS AT DUNSA (GWP) 169 pts.

Mrs P Thomas and BONZER HONEY-SUCKLE BLOOM (Lab) 166.5 pts.

Thanks competitors for entering. I wish you all success at your future trials. Also I do apologise for the lateness of this report due to a blip on my part.

* * * * *

1st - 6th November 2005
Tollesbury

STAKE: CD

**Judge: ERIC NICHOLLS
Control Steward: Elaine Ford
Search Steward: Adrian French**

Thank you ICENI for the invitation to judge the CD stake at you Championship trial and to Les Theobald for running the trial in his usual efficient manner.

There were 19 entries of which 10 worked on a nice grass field. The agility appeared to cause the main problem today with no dogs gaining full marks.

1st Tony Lockyer with DOUBLE TOP AT HARTSHILL. A nice round by this experienced handler. Full mark square and retrieve. Well done Tony. 90.5

2nd Sharon Webley with ARRONBANKS SPOTTA BOVVA. Very close marks on the agility. Well done. 84

3rd Felicity Boulderstone with UTHYR DRAGON. I am sure you will qualify next time. Good luck. 77.5 CD only

4th Rita Banfather with STARCO MY GUY OF BANNESAWAY. The down stay and sendaway were very costly today. I am sure you will sort them out. Good luck in the future. 71.5 NQ

Finally a big thank you to my stewards who all did an excellent job; search steward Adrian French, control steward Elaine Ford and Estelle Hook for ensuring all competitors arrived at the right place on time. All first timers at stewarding at a trial.

ASPADS
CHAMPIONSHIP WORKING TRIAL

Oxford
12th - 18th February 2006

STAKE: TD

Judge: TONY ORCHARD
Search Steward: Lynne Liney
Track Layers: Steve Liney, Mark Richards, Roger Shrimpton, Len Newman and Linda Bowden run off tracks.
Control Steward: Jenny Orchard

67 Entries

Thank you to ASPADS for inviting me to judge my second ticket. It is a special privilege to set a test for the best handlers and dogs in the country.

Thanks to Len Newman who managed the trial in a very efficient and friendly manner, organising the land and order of work to the advantage of dogs and handlers.

Conditions for nosework were probably the best I have experienced at Oxford with good growth, very mild temperatures and apart from a very wet Sunday basically dry.

The track had 21 legs and approximate 930 yards, the first article was a 3 inch length of television aerial wire, then a 3 inch house plant stake and the last an 1.5 inch piece of hosepipe.

We were treated to some excellent tracking with good line handling particularly on the tracks where there had obviously been game. The searches were generally well done with dogs working enthusiastically and covering the square, any articles missed were because the dog did not work the whole area. The articles were a plant tie, 2inch cord, bottle top and piece of thin material.

There were 25 with qualifying marks after

the nose work.

The control day was cold with a very foggy start so I was relieved to be able to see the two send away markers. The out run was 120 yards out and to the left, with a 130 redirect coming back and to the right across the front of the handler.

There were 11 good send ways the only full marks going to Mrs Tohme's Weim. bitch FURSDON TWYLITE TRAMONTANO.

The speak was with the dog tied to the front of a car with the handlers then positioned 35 yards away with back to the dog. There were 14 good speaks with 7 barely making a sound.

The heel work saw 15 good rounds. The rest was pretty dismal for a ticket stake.

The gun test was set up on the tracking ground simply walking across the front of me with the dog at heel the gun was fired once when handler and dog passed me. I positioned myself four paces from the dog.

1st 209.5 Mrs J Webb FLYNNTASTIC WININ Venture WSD D A dog and handler working on top form and it showed on the track, the search square and the C&A. It was a real pleasure to watch, a team enjoying any challenge they meet. Congratulations on your CC and subject to KC approval a Working Trial Champion Certificate.

2nd 201 Miss P Herbert WT.Ch JOLLY JILL WSD B Another good all round team performance. The best track mark - it was a shame everyone could not have watched, but very unfortunately missed the first article. A very professional C&A round. Congratulations on the Reserve CC. Well done.

3rd 198 Mrs A Bussey WT.Ch ROMENO IF SIX WAS NINE WSD D A display of line handling on land well visited by deer,

this team really had to work, all three articles then pulled off a full mark square. A very worthy 3rd place after a run off. Well done

4th 198 Mr D Marchant WAGGERLAND MURPHY WSD D A superb track with three articles missed the plant tie in the square. Held it together in the C&A with a good speak and out run on the send away. Congratulations a worthy place.

Qualifiers

192.5 Mrs E de Unger BARNSTHORN STRIKE IT LUCKY LAB D

194 Mrs A Fowler WTCH WAGGERLAND FLOSS BC B

186 Mrs M Reagan KENMILLONE FRASER GSD D

189 Mrs A Tohme FURSDON TWYLYTE TRAMONTANO WEIM B

181.5 Mrs M Weselby STYPERSON TAY LAB B

184 MR & Mrs J R Wykes FLYNNTASTIC RED JAFF OF TARNFORCE BC D

TD only

171 Mrs S Ashby THE ECHO WSD B

I would like to thank all the tracklayers who without exception put the tracks down to the advantage of the competitors, taking account of all the variables that good experience track layers automatically do, you did a great job. A special thank you must go to Steve Liney who was out there for six mornings putting down the earlies. Think how important that is to the trials, well done.

Lynne also deserves special praise for laying the squares every day and putting up with me, again you did a brilliant job.

Jenny acted as my control steward and scribe on the Saturday giving all the competitors clear easily understood instruction giving them the opportunity to perform to their best.

Throughout the trial Lee was working away in the background producing refreshments for during the day and excellent five star meals in the evening. To you and all the various helpers that popped in I very much appreciated your efforts.

Thanks to Arthur Jeal for escorting and Jean Howells for looking after the scores and base.

Finally thank you to all the competitors for entering under me and showing such sportsmanship, without exception you are a credit to trials.

* * * * *

NORTH EAST COUNTIES WORKING TRIALS SOCIETY OPEN TRIAL

Ashington

17th - 19th February 2006

TRIAL MANAGER, REPORT

Firstly, I would like to thank the staff at the Woodhorn Grange for the use of the room for the Base. It was brilliant. Close to everything, with very little travelling.

To ALL my helpers, thank you all so very much. You made my job as Trials Manager so easy, it was a pleasure to work with you all. From Betty Orrin for the catering to Ann Bedford coping beautifully with the base.

To our Judges and their Stewards and Tracklayers, thank you all for your time and patience. Hope you liked the weather, cold but dry. And again, to Jim our Farmer, thank you for all your help. Finally, many, many thanks to John Watts for not only his usual help with the land, but also for his help with finding our new Base at Woodhorn Grange. Special thanks to Pat

and Dennis and Betty Orrin for the accommodation.

LOL CAMPBELL

STAKE: WD

Judge: PETE HODGKINS

Steward: Amy Parkinson

Tracklayers: John Watts, Stevie Braithwaite

Thank you NECWTS for the invitation to judge the WD nosework at your open trial. Your new base Woodhorn Grange is perfect with all tracking land and the control field close by. Well done John Watts for getting this.

Trials Manager Lol Campbell and his team made sure the trial ran smoothly. Thank you all very much.

I had 12 entries (10 ran). Weather was good. Tracking fields were sparse rape. John and Stevie laid all the tracks and Amy was laying squares for the first time. Many thanks to each of you for a job well done. All dogs recovered 3 or 4 articles from the square. Only 4 dogs completed the track.

1st Moira Rogerson with SELDOM-SEEN RIO (WSD). Did not find the track easy but your experience got you round with two articles and a good square. 84.5 - 20 - 34. congratulations on this win. 191.5 Q Moira also won Best Nosework trophy.

2nd Penny Pritchard with GRACORN HOME BREWED (GSD). Tracked steadily and accurately - made it look easy. Square needs a little more motivation. 89 - 20 - 24. I was so pleased you qualified. 185.5 Q.

3rd Doreen Waite with PRINCESS VAL-LONTHORPE (BC) - same marks as fourth placed dog - awarded 3rd place due to higher track mark. It was good to watch. 88 - 10 - 32. very well done. 183 Q.

4th Laura Bardwell with TSAR PRINCE AMARUKA (Rott). I was impressed with the way Laura handled her dog on the track. Good to see different breeds doing well. 85 - 20 - 26. Congratulations on your qualification. 183 Q.

Finally to all my competitors, thank you for accepting my decisions and I hope you enjoyed your day.

STAKE: TD NOSEWORK

Judge: PAT HODGKINS

Steward: Lorraine Wilson

Tracklayers: Dave Todd, Andrea Lynd

It was a pleasure to judge the nosework for TD at Ashington. Thanks to the committee of N.E. Counties for the appointment and to Lol Campbell and his helpers who made sure we were well looked after. The food bags were very welcome - thanks to Betty and Co. and thanks Ann for keeping things in order at base. We were blessed with good weather for the 3 days out on the fields. Lorraine was a great search steward (where was it you kept the articles?). All dogs recovered 2 or more articles. Thanks Lorraine for all your help and for being such good company.

Tracking was on grass and conditions were good - wet in places, but this did not seem to affect the dogs. We saw some excellent tracks. These were laid by Andrea and Dave, two very experienced tracklayers. A huge thank you from myself and competitors.

1st Rob Currie with VOMHAUSNYE PUNK (GSD) tracked on the 3rd day. A very keen dog, well handled. The fastest search square. Track 97/30 search 34. A

well deserved 1st place. 211.5 Q.

2nd Debbie. Meade with HEATHER-MARK LING (GSP). Georgie did a good solid nosework round. One of only 2 dogs to get round the track on the 2nd day. Track 93.5/30 search 33. Well done.209.5

3rd Yvonne Carpenter & CARFELD GRIFF (BC). This was a real team effort on the track. I know you were thrilled with this qualification. Good Luck in the future. Track 92/30 search 34. 209 Q.

4th Gary Martin & TYTRI ROY (BC) A good track and search track 94.5/30 search 34. 203 Q

Congratulations to the following qualifiers;

Lindsey Errington & CASTLESIDE YOUNG JET (Lab). 202.5

Betty Orrin & VASHIKA XASKIA ON MERLOCK (GSD) 201.5

Jacque Hall & MERCURY SKYLARK (G/R) 191.5

Stevie Braithwaite & NORSHEP SHULA (GSD) 183.

Best nosework trophy went to Kath Woolley with TYNSIL TIGER WALKS AT DUNSA (GWP). Finally I would like to thank the society for my birthday present - a lovely surprise.

* * * * *

**NORTH WEST WORKING TRIALS
SOCIETY
CHAMPIONSHIP TRIAL**

Lower Witherington, Near Knutsford.
Week Ending Sunday 26th February 2006

STAKE: PD

Judge: ALAN BOLTON

Thank you for the invitation to judge the P.D. stake at the North West Championship Working Trial. There are so many people from the North West Society who I would like to thank for their friendship and support but if I started naming names I would miss someone out so suffice to say a big thank you for making Lorna, my steward, and I so welcome.

To the trials manager Dave Bell you ran an excellent trial, we wanted for nothing. Also thanks to the catering staff who kept us fed and watered and to Ricky and Ken Davies thank you for your kind hospitality and not forgetting the delights of Ken's culinary skills. To my tracklayers Chris, Ray and Ron you all did a fantastic job, thank you. My criminals were Tom, Steve, Chris and Ron as always they were brilliant. I tell them what I want and I don't need to worry about it - they do it in a professional manner. The thing about these men, apart from Ron, is that they don't work a dog, many thanks you were brilliant.

My steward from start to finish was Lorna Cottier who not only did a first class job during the trial she was also excellent company. The only down side was when Scotland fluked a win over England at rugby I had to listen to her bleating on about it.

All dogs qualified in the nose work.

The dog's first exercise was steadiness to gun followed by the track. During the track Lorna put four poles out for the square, no articles were put in at this time. On completion of the track the competitor was required to impress me with heel work in the square for 1 minute, on completion of which the competitor was required to leave the square, put the dog in any position they required with its back to the square, walk 10 paces away from the dog keeping their

back to the dog and looking straight ahead get the dog to bark. As this was being done Lorna was placing the articles which were a cotton bud, blue bottle top, piece of leather and a 1" piece of green welly in the square. Apart from the heelwork which was disappointing overall, the other exercises were done quite well.

This left the sendaway to do & the control. The outrun was 120yards to a bluepole with a 150yards redirect to the left. Two competitors got maximum marks. This was followed by the agility - all teams qualified in this section. There were ten qualifiers going into the Patrol round and it started with the Quarter.

I required the handler to send the dog around a field to a large oak tree to locate a criminal who was hiding there, this was the only exercise where I required a search to be carried out. An axe was stuck in the tree along with a Stanley knife concealed on the criminal. Once this incident was dealt with I required the handler to send the dog further around the field to where another criminal was hiding. The handler was required to take the first criminal to where the second criminal was. Only one dog completely failed this exercise and I saw some very good quarters. The escort with the attack on handler which followed this was the poorest exercise overall. During this exercise the handler was attacked twice, the first being approx 100yds into the escort. As the handler was calling the dog off the second criminal was attacking. Handlers were finding it difficult get their dogs to walk to heel and to get them off the first criminal and direct onto the second, however there were a couple of good ones. The chase followed, two criminals running away with one stopping en route while the other kept running. Handlers were instructed to ignore the sta-

tionary criminal and go to the criminal the dog had detained. Immediately the handler got to the dog the stationary criminal ran back towards the starting point. I awarded a maximum 10 points for the 1st criminal and 20points for the 2nd, 4 got maximum marks only 2 got 10.

The recall was set up exactly the same. The recall off the first criminal was done very well with only one competitor getting no points.

The second criminal was running directly at the handler so it was necessary for the dog to pass the running criminal to get to the handler, one handler got maximum marks and she was heard to say when on her command her dog turned away from the 2nd criminal" OH S...T I DIDN'T EXPECT HIM TO DO THAT"

I judged the same as the chase and detention 10 for 1st and 20 for the 2nd. The Test of Courage had 2 men standing 30yds away with dustbin lids & another with a length of polystyrene. All 3 approached the dogs in aggressive manner. I wasn't looking for the dog to go through the bin lids to bite the sleeve rather a dog that wouldn't back off and I wasn't disappointed. I think overall this was the best exercise.

My thanks to all competitors for accepting my decisions, well done to you all and good luck in the future.

1st Rod Roberts with x breed W.T.Ch. LITTLE BART. Consistent throughout all the exercises, a thoroughly professional round. Well done and good luck at the K.C.C's. 295/320

2nd Graham Brumpton with his W.S.D. W.T.Ch. JUST WILLIAM Another good consistent round the second recall costing this team dearly. Well done. 287/320

3rd Mick Tustain with his Malinois JOTUNHEIM VIP. A very keen young dog

superbly handled by Mick, a pity about the reluctance to locate the criminal immediately and a bite in the first hide. Well Done. 281/320

4th Dave Marchant with his W.S.D. W.T.Ch. WAGGERLAND MISTER JAKE. Started well with best track losing only 1 mark but lost too many marks in the other exercises to be in serious contention for the ticket but still a very good round. Well done. 278.5/320

Also qualifying P.D.ex

Celia Bourne with her W.S.D. KAIS KIN-DRED SPIRIT Well done Celia and it is not true what you suggested about Heather "All in good Fun" Well done. 277/320

Heather Patrick with her W.S.D. XAN-DOAS QUIZMASTER Heather as usual was a barrow job as she approached me to do each exercise. Just qualifying with not too much to spare, she approached the Patrol round in the same manner saying she didn't know what she was doing there, then proceeded to put together the best patrol round of the day and get her first P.D.ex. This was followed by a pitch invasion led by Moira Rogerson (you can't keep Moira down) Well done Heather 259.5/320

LEE PAYNE with his W.S.D. SWEET ASSASSIN I know Lee has been having problems with this young dog however got the best out of his dog with the best quarter of the day. Well Done 259/320

Qualifying P.D. only

Polly Thomas with her W.S.D. STANLEY OF ANNESLEY SPRINGS You are nearly there Polly. Well done. 245/320

To all competitors, I enjoyed judging you and the friendly banter Thank you all.

B.A.G.S.D. OPEN TRIAL

Devizes, Wiltshire.

25 - 26 February 2006

TRIALS MANAGER'S REPORT

There are always so many people involved in a successful trial, but the definitely indispensable are the long suffering farmers who let us come back year after year to play games on their land. My usual farmers were as cooperative as ever, with Rachel and Jonny Rider and Charlie Rudler lending me fields for nosework and C&A and Andrew Brown letting us use the car parking facilities. Hard standing parking is pretty important in the Pewsey Vale in February.

We did not have very good entries this year with only 13 in WD and 11 in UD, but that was certainly no reflection of the judges, Allyson Tohme and Rob Currie, who both set lovely straightforward tests. The lack of qualifiers (only 2 UD) was more to do with the high winds and very cold conditions on the tracking ground than anything else.

Most of my usual helpers turned out again and some had a variety of jobs as ill health prevented a couple of people coming at the last minute. Allyson came over to help me set up the jumps on the Friday and we were joined by Lindsey Poole, who also laid UD tracks for two days and WD tracks for one day (and wrote out the certificates!). Pippa Bentham laid UD tracks one day, then turned into a square steward for both stakes on Sunday. Heather Cook was pressed into service at the last minute, square laying and stewarding UD on the

Saturday. Linda Bowden laid WD tracks both days and Barry Cook laid WD tracks one day. My long-suffering husband, Tim (who had not arrived home till Friday evening) was also busy laying squares for WD on the Saturday. The whole gang was great, and, hardly complained at all about the bitterly cold wind. Mind you, there was the reward of home made hot soup and pizzas, bacon butties, garlic bread and home made cakes back at base, all provided by Vicky Wilford. Her talents in the kitchen are truly awesome!

Thank you to the competitors, too. There was only one thoughtless person who did not turn up and had not bothered to contact me. Luckily, we did not lose a track. I would hate to have thought that one of my tracklayers was freezing out in a field for nothing. The rest of you were a lovely cheerful bunch even if you did not do as well as you may have hoped. Better luck next time.

MARNEY WELLS

STAKE: WD

Judge: ALLYSON TOHME

Tracklayers: Linda Bowden (2 days), Barry Cook, Lindsey Poole (1 day).

Square Stewards: Tim Wells, Pippa Bentham

Catering: Vicky Wilford

I would like to express my thanks to the Association for the invitation; the Trials Manager, for the outstanding organisation; my tremendous tracklayers; superb square stewards; and the competitors for entering under me and accepting my decisions gracefully.

Vicky dwarfed Gordon Ramsey in the hos-

pitality stakes and had the trial run any longer I would have been in danger of reaching hippo like proportions from the consumption of her delicious home made food!

13 entered, 9 ran, including 4 breeds.

Being cognisant of the fact that WD Open could represent only the second competition for some teams I set a straightforward Control Round commencing with the retrieve, a straight line of heelwork to a sendaway of 100 paces to crossed poles followed by the Agility Section where second attempts were allowed at all obstacles.

Stays were the downfall of three of the teams with only one dog going out on the Agility. Sendaways were generally well performed and heelwork was very competent. All dogs gained full marks for the gun; retrieves were mixed.

Tracking (10 legs) was on Rape; unfortunately the weather- bitterly cold with very strong winds, spelled defeat for all but the two most experienced dogs/handlers. Enthusiasm, greenness and speed are not the best combination in such conditions. Everyone got at least two articles from the square, most three and some all four.

Track articles: a) wooden stirrer b) green plastic handle.

Square articles: metal teaspoon, 3" x 3" square of green scourer, 5" length of green rope, 4" piece of electric wiring.

I saw some very promising dogs, excellent handling and super control and agility performances.

Unfortunately the test, dogs, handlers and judge were beaten by the uncompromising

climate therefore I was left with no qualifiers.

1st Miss C S Young with MALI OF MEADOWWALK CDex, BC (B)

This little bitch worked her socks off to get round the track with one article recovered and 3 from the square plus a full mark retrieve. What a shame about the stays.

2nd Mrs L Coull with FURSDON MID-NIGHT MONSOON CDex, Weim (B)

A lovely nosework round from this bitch earned her the well deserved "Best Track" award.

3rd Dr N Prescott with DUNNSLAYNE DASHA WSD (B) All 4 articles out of the square and full mark jumps.

4th Mrs J Brine with LAETARE JUBILEE BC (D) This dog made a determined effort, recovering the first track article with ease but just could not outdo the wind.

Best C & A Round: Polished execution by Mr J Simpson with GLENROYAL YAZZ, a very stylish GSD bitch. 53.5/55

The only full mark sendaway: Mr R Willatts with MOORMILL NILANDU a FCR that never looked as though he would run out of petrol.

I hope you all enjoyed the trial as much as I did, despite the "negative player outcome", and I look forward to seeing you all in the higher stakes.

* * * * *

**POOLE & DISTRICT DOG TRAINING
SOCIETY
OPEN TRIAL**

3rd - 4th March 2006

Ibsley Village Hall, Nr. Ringwood, Hants

STAKE: UD

Judge: PAUL COUSINS

Steward: Tracy Coutts

Tracklayers: Arthur Jeal, Mary Drewitt and Val Thomson

Many thanks to Poole & District DTS for inviting me to judge their UD stake, Mary and Melvin made me feel very welcome. My thanks also to my tracklayers and to Tracy for providing excellent support during the day. If you are invited to judge at Poole forget the diet. Sharon, June and Carol in the kitchen will ensure you are tempted with bacon rolls and irresistible cakes.

We were lucky with the weather and had plenty of sunshine during the day with little wind. The competitors were a friendly bunch with enthusiastic dogs, all of which combined to make it an enjoyable day for me, and I hope for the competitors as well. I set what I thought was a straightforward send away, a large, lone tree in the hedge about 70 paces away, but several dogs had a problem understanding where they were supposed to go.

1st Rita Banfather and FINN Q 186. Very nice nose work, only dropping 2.5 marks on the track, followed by a good C&A round. One of the few to do a good send away. A deserved qualifier and winner.



photo by Rosemary Turner

2nd John Reynolds and KELLY Q 175.5. Another good nose work round. The send away let them down on the C&A round.

3rd Gavin Thomson and ROSCO Q 172.5. Good nosework, followed by an excellent C&A round. The only full marks send away. Missing the first article on the track proved hard to make up.

4th Jane Gray and TARKA NQ 157. A good track but only 2 articles from the square kept the nose work marks down.

STAKE: WD

Judge: ANNE BUSSEY

Tracklayers: Arthur Jeal & Paul Cousins

Steward: Val Thomson

I would like to thank Poole and District for asking me to judge the WD at their open trial when Margaret Robinson was unable to undertake this appointment (our thoughts are with you at this difficult time Margaret). Thanks also go to my very conscientious track layers Arthur and Paul

who both did a tremendous job -thank you both. My steward Val laid the squares exactly as per my instructions and then guided the competitors around the control field without a single hitch - thanks Val. Val and Gavin also provided me with four star accommodation and pampered me well (I hope I did not infect too many people with my mega-cold!) thank you both. Thanks also to Mary and the gang in the kitchen you were fantastic! We were treated to home cooked meals at base in the evenings and a constant supply of hot food and drinks, through the day. The atmosphere at Poole is second to none, thank you all.

Out of nine entries six ran and we had two qualifiers after the nosework. The competitors were a super bunch all working hard to get the best out of their dog on the day. Thank you for allowing me the privilege of judging your work. All of you are capable of qualifying at this level with a little more training, experience and luck!

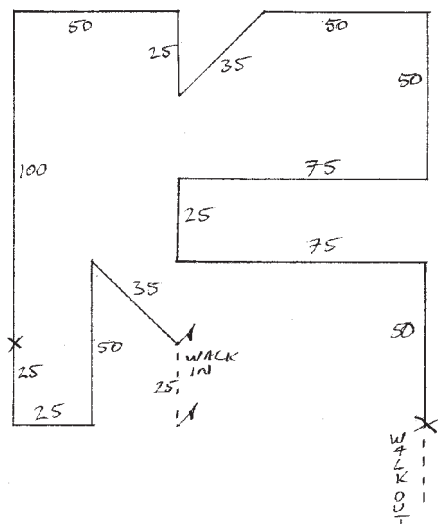

1st Mrs. June Coutts with HORSE-DROVE HENRY UDex. (Lab). Very competently handled by June. Super track

locating both articles, three out of the square and a creditable control round secured this well deserved qualification. Congratulations! 179/200.

ESSEX 2000 OPEN TRIAL

2nd - 5th March 2006
Billericay



photo by Rosemary Turner

2nd Miss Vreli Middleton with SHARDEE'S JODI CDex. (GSD). Another good track with both articles and four out of the square. Followed by full point agility - but oh that sendaway! Retrieve improved since I last judged this pair, keep at it Freddie 164.5/200 NQ.

3rd Gillian Storr with GEFNI VERY VOCAL CDex. (GSD). Foxy really pulled into the track and with a little more experience Gill will follow her confidently and gain more qualifications! Three out of the square, the only dog to hold and return the articles without penalty. Also the only clear heelwork of the day. Well done Gill. NQ.

TRIAL MANAGER'S REPORT

Well this was another successful trial for Essex - 2000 and thanks go to all those who gave up their time to help from judges to tracklayers and stewards, and catering staff to escort and general dogsbodies, and to all those who help set up before the trial and clear up after. Thank you all. I would like to say a special thank you to my good friends Mandy and Johnnie Bridger, who although have nothing to do with working trials, came down on the Saturday morning to do the catering. Thanks you two, it really was appreciated. Thanks to our tracking land farmer and a very big thank you to David our base farmer. You really are one in a million. Thanks David.

I will leave the judges to thank their individual helpers in their stakes but would just like to say thanks to Mike Woods, who started the day as square steward for Bob Cook but ended up judging the UD nose-work due to Bob being taken very unwell and unable to continue. He is now improving slowly. Thanks to the tracklayers Jan Vallack and Dave Self who laid tracks and took over laying squares. Thank you all for just getting on with it.

The weather was kind to us, in that it didn't rain and it wasn't windy. The only thing was it was so cold it froze everything and I do mean everything. All the water pipes, taps, loos, water containers and everything in the caravan were frozen solid. But

everyone just got on with it. No complaints, just saying "Lynne where can I fill this bucket with water so I can flush the loo". Trials folk are a great bunch, they just get on with things.

I hope you all had an enjoyable trial and had a safe journey home.

LYNNE BAKER

STAKE: PD

Judge: PETER CARROLL

Tracklayers: Mark Lewindon

Steward Squares: Steve Lancaster

Patrol Steward: Joan Miller

PD Helpers: Steve Lancaster, Tom Davis,

Penny Belis, Mark Lewindon

Food: Sandra Lewindon

Special thanks to everyone involved with the trial. Thanks to the society for the invitation to judge. My team, perfection in every respect Only have one thing to say Mark my track pattern will be harder next time. We had good weather, no rain plenty of sun with a light breeze. The dogs and handlers were a pleasure to watch and judge.

1st Wendy Beasley GLENALPINE PHEOBY OF STARDELL 288 Q. worked nearly perfect in every section a worthy qualification.

2nd Paul Beasley GRELGANNA LEO OF STARDELL. 255 N Q Not Paul's day.

3rd Richard Cornwall KAUFENBERG GRUBER 158.5 NQ.

* * * * *

LEAMINGTON DOG TRAINING CLUB OPEN TRIAL

4th - 5th March 2006
Pailton, Warwickshire

STAKE: C.D

Judge: JENNY ORCHARD

Steward: Anne Shepherd

I would like to thank Leamington for the invitation to judge the C.D stake. As usual this was a well run trial by David Barker trials manager, never an easy job. We were superbly fed and watered by Dot Levin and with Julie Skip keeping the base under control, nothing was left to chance. Lastly but not least thank you Anne Shepherd for keeping the stake flowing and putting competitors at their ease.

Thank you all!

I set a straight forward test, the articles in the square being a jam jar lid, piece of carpet and a 6 inch black plastic handle from a wine box. The searches were good with Anne only having to retrieve one article from the seven teams that worked. The control commenced with heel on lead followed by a diagonal recall, heel free and finished with a 45 paced sendaway to crossed poles in a hedge. As is usual in C. D the problems occurred with the jumps and stays so I ended up with three teams achieving qualifying marks.

1st 94.5 Q Jackie Weaver LENWOOD BRYONY Lab Lovely nose-work and just minor blemishes on the control. Full set of jumps

2nd 89 Q Mrs Eleanor Mestraud WOLFHART CASSEY GSD Three articles recovered from the square and a slight

hic-cup with the clear jump but I am sure that you will not retire Rekka after to-day.
3rd 85.5 Q Mr and Mrs B Wood JINGALING OF JANETSTOWN CDex Shetland Sheepdog Handler Carol Wood. Lost 2 on the retrieve, lovely sendaway and a full set of jumps.

4th 81.5 Q Mrs D Levin IVYMOOR DAX Weimaraner Dax was confused by the sendaway but otherwise a lovely round.

Congratulations to those that qualified, and to the others I am sure it will not be long before you too are successful. Thank-you for entering and accepting my decisions, I really enjoyed judging you and your dogs. Good Luck for future trials.

STAKE: WD NOSEWORK

Judge: ALISON DAVIDSON

Stewards: Sue Lawrie Sat. Sue Drake Sun.
Tracklayers: Maurice Cooke, Jane Sutherland (Sat.) Norma Ansell, Jane Sutherland (Sun)

Many thanks to Leamington DTC for the invitation to judge. Thanks also to David Barker as Trials Manager ably assisted by Julia Skipp at base, Dot Levin for our snack boxes and Zoe Finlay for breakfast on Sunday. The tracks were laid by Maurice Cooke and Jane Sutherland on Saturday and by Norma Ansell and Jane Sutherland on Sunday. Squares were laid by Sue Lawrie on Saturday and Sue Drake on Sunday. Many thanks to all of them for a job well done.

Nosework was mostly good with some excellent tracks. The results were as follows:

1st David Holt & CHARLESTOWN

JAKE (GSD). Superb track. Very steady and accurate (got the scourer yet?). 180 Q.
2nd Jenny Holt & HULLATER BROOK (WSD). Slow start but lovely track after the first leg. 174.5 Q.

3rd John Simpson & GLENROYAL YAZZ (GSD). Excellent nosework and very well handled by John. Lovely attitude from dog and handler. 179.

4th Steve Liney & GEMSTONE EASTER wish CDex. (Xbreed). Good teamwork from Steve and Gem. Steve reads this dog very well. 178.5.

STAKE:TD NOSEWORK

Judge: VANA MOODY

Steward: Lisa Coul (Sat) Zoe Finlay (Sun)
Tracklayers: Sue Ashby, John Wykes (Sat)
Sue Ashby, Maurice Cooke (Sun)

Thank you to the committee for asking me to judge and to all competitors for accepting my decisions, Julia Skipp at base, Dot Levin for catering. Sue Ashby for her B&B.

My stewards and tracklayers did all I asked and were good company, thank you for your time.

The fields were great with very good conditions generally. The standard was pretty good, with some dogs coping very well, some just not up to it on the day. Better luck in the future.

1st Hazel Burton with STAR. Very nice and has sorted the corners now, not so much casting. Well done. Track 94 + 30 square 35.

2nd Lesley Jones. A happy working dog, once started, had us worried to begin with but then flowed. Congratulations. Track 96 + 30 sq. 25

3rd Roger Shrimpton a precise worker, just a couple of slips nice to watch.

Track 96 +25 sq 34

4th Jeanette Sayer a joy to watch this pointer 'power' round the track. The square needs a little attention. Track 98 + 25 sq 25

Also qualifying;

June Read Well done, few bits to brush up on. Track 94 + 15 sq 31

Alan Ballinger Well done just a few tidy ups needed. Track 94 + 25 sq 26

* * * * *

**LINCOLNSHIRE GSD ABTS
CHAMPIONSHIP TRIAL**

10th - 12th March 2006
Dunholme Village Hall

STAKE:UD

**Judge: VANA MOODY
Steward: Ann
Tracklayers: Jim Sewell, Ann**

Thank you to Nigel and committee for asking me to judge. There was super fields with excellent conditions. Although bitterly cold it did not affect the dogs on Saturday but Sunday was even colder which did have a slight effect on the squares. The standard was very good with some lovely tracks and sendaways. Agility had a few blips. Those that did not qualify, keep trying - it should not be long.

Thank you to Jim and Alan for laying the tracks and Ann for putting out the squares, Jim also stewarded the C/A putting everyone at their ease. Thank you all for your time and good company. To Bob and his 'kitchen staff' thank you for all the goodies.

1st Moira Rogerson. RIO was a worthy winner dropping 2 marks on the track.

Squares and C&A were a pleasure to watch. Well done. Track 88 + 20. square 35 control 35 agility 20. 198 Q.

2nd Jenny Holt. BROOK gave a good overall performance, just a little more work on H/W to tidy up and to channel the 'over keen' retrieve. Missing one article on the track was costly. 86 + 20: 31: 31.5: 19.5. 187 Q.

3rd Jacqui Gibney BRYN'S track and square pulled the marks up from the basic C&A. just needs tidying up. Well done. 87 + 10: 32: 25: 14. 168 Q.

4th Hilary Mercer. PENNY had a little problem with the track but her general work helped her to make the qualification. Well done. 76 + 10: 26: 32.5: 17.5. 162 Q.

* * * * *

**SOUTHERN ALSATIAN TRAINING
SOCIETY
CHAMPIONSHIP TRIAL**

13th - 18th March 2006
War Memorial Hall, Nutley, East Sussex

TRIALS MANAGERS REPORT

This trial was held between 15th & 18th March, at Nutley, East Sussex. TD was held on Ashdown Forest as always, what would a SATS trial be without the forest. WD & UD were held on farmland, down at Uckfield.. Here we held all the control plus CD.

I would like to thank all the judges for their fair and honest tests, John West TD, Dorothy Bowen WD, Ron Jaques UD and Chris Brooks CD.

The weather held out but it was very cold, typical SATS.

I would like to thank Frances Webb for all

her help running up to the trial, plus her and her band of caterers, Sue Redshaw and Carole Brooke who kept the judges, stewards and tracklayers feed on rolls and hot stew in the cold conditions. All of these also managed to work their own dogs at the trial and Frances also stewarded the TD control.

Special thanks to Mark Skillin for the catalogues and to Di Boxall for giving up her days to sit in the car parks on the forest to keep an eye on the judges, helpers and competitors cars and belongings.

I will let the judges thank their individual helpers in their on reports.

I will probably miss thanking someone so thanks to all who helped at the trial.

Oops, nearly forgot, a **BIG, BIG THANK YOU** to Jane Gray and Ruth Payton, for all their help in running this trial and putting up with myself, Julie and Trim for five days.

Congratulations to all the winners and qualifiers, and thank you to all the competitors for entering.

STEVE SKILLIN

UD STAKE

Judge: RON JACQUES

Thanks to SATS for the invitation to judge. Thanks to Steve Skillin and all his helpers for running a super trial. also my thanks to all the tracklayers who did a super job.

John and Barbara on Friday.

And Penny and Dave on Saturday.

Thanks to my wife Paula for laying the squares and stewarding C/A.

The weather was very cold but tracking conditions were good on grass. We saw some lovely dogs and quite a variety of

breeds.

There was 15 entries 11 ran

1st Steve Liney with **GEMSTONE EASTER WISH.196.5 Q**

Superb performance, losing only 1 mark on control and agility and a super track and square a super team effort and lovely to watch. well done Steve and Gem.



2nd Tony lockyer with **DOUBLE TOP AT HARTSHILL 194 Q.**

Another super all round performance from a very experienced handler. well done Tony and Gyp.

3rd. Robert Willatts and **MOORMILL NILANDU 183 Q**

Lovely control round. Well done Robert and Dax.

4th Angela Gourd and NICKILA RED. 177.5 Q well done Angela and Tarn. Also qualifying. Rosemary Woods and HOLLEY COLLIE. 177 Q. Well done Prof. Mike Robinson with FLINT OF GLEN MEL. 170.5 Well Done

STAKE: T.D.

Judge: JOHN WEST

Tracklayers: Len Newman, Ruth Payton, Dave Spicer, Den Webb

Stewards: Squares. Jane Grey, Control: Francis Webb. Stay Stewards. John Reynolds, Lyn Liney

Thank you to SATS for the invitation to Judge their ticket on Ashdown Forest. There has been quite a change to the terrain since my last visit. I must applaud all my tracklayers and stewards as the weather all week was absolutely bitter. Even after walking around the forest it took a number of hours to warm to the bone. Thank you all very much.

I set a straightforward test with articles applicable to the forest but as normal with an undulating ground some fell by the wayside. I continued with a no gimmick control round. This also produced one or two surprises for the dog's handlers.

I would like to finish with a thank you to John Reynolds for his accommodation and to John, Jane and Ruth for the food and hospitality in the evenings and to Francis Webb and Sue Redshaw for the food during the day, great casseroles as the weather was so cold it really hit the spot.

1st Judy Meekings WITHYLINCH MURR OF WINDLEBROOK C.Dex-W.Dex. (Lab) 205 Q. As I said above there was nothing untoward to trick a dog or handler, Megan and Judy made no big mis-

takes so turned out to be worthy winners.
2nd Colin Harrison SHINEHILL NINA C.Dex-W.Dex. (BC) 202 Q. Nina took Colin by surprise by failing one jump but wasn't the jump he thought Nina would fail, however a ticket is well within your grasp.

3rd Pat Herbert WT.Ch. JOLLY JILL C.Dex-T.Dex. (WSD) 198 Q Another contender for winning the ticket, however the forest kept one of the track articles making it difficult for the control round. (Full Mark Square)

4th Eric Nichols TYTRI NIKKI C.Dex-T.Dex. (BC) 197 Q Another loss of one article on track but as above a full mark square

Also qualified

Geoff Mayes RUNFOLD TEMPEST OF OBERAN (WSD) 196.5 Q

Elizabeth De Unger BARNSTORM STRIKE IT LUCKY (Lab) 195 Q

Colin Ball CONNEY WARREN TUCKER BOX (Lab) 190 Q

Stella Smyth MORROW RED CHAKOLA (ACD) 185 Q

Best Track

Ray Jones HOLLY BY GOLLEY (WSD). With the weather being so cold it was a real pleasure to see Ray and Holly track with such accuracy.

* * * * *

**HUCKNALL AND DISTRICT
OPEN TRIAL**

17th 19th March 2006
Crich, Derbyshire

STAKE: UD

Judge: MAEVE WESELBY

Tracklayers: Joan Snowdon and June Hinds

Steward: John Weselby

Thanks to Hucknall & District C T S for the invitation to judge UD stake and to Trials Manager Cyril Barke and his team for all their hard work. I would like to say a special thanks to the main people. Without their commitment this trial would not be possible - my two happy tracklayers Joan and June and John, who stewarded for me.

Of the 21 entries 18 competed in extremely cold, windy conditions. Whilst the majority completed the track the stays took its toll.

Thank you to all the competitors for entering under me. It was a pleasure to see you and your dogs work. Better luck next time to those who missed out and well done to the few that qualified.

1st K. Ingham with RUSKATH OTHENTIC IMAGE (B) WSD 180.5 Q

2nd J.D. Miller with FOXFOLD COALITION (D) GSD/WS 180 Q

3rd G.G Pryce with CONCERN XCELL (D) GSD 178 Q

4th F Williams with HEATON BRIDGE HONEY (B) LAB 170 Q

Also qualifying

L. Campbell with SELDOMSEEN SHEP (D) WSD 166 Q

STAKE: TD

Judge: SHEILA TANNERT

Tracklayers: Jim Pepperdine & Malc Snowdon

Steward: David Watie

I would like to thank Hucknall and District for the invitation to judge. I would also like to thank my tracklayers Jim and Malc.

It's not easy fitting TD tracks in to those small fields - you both did a great job. David my steward did a great job, as usual laying all the search squares and stewarding the control and agility.

The weather wasn't very kind to us. It was freezing cold with snow showers on Friday. On Saturday it was just very cold, but on Sunday the sun actually managed to get through.

To those who qualified "well done". To those who didn't, keep trying, I'm sure it won't be long before you qualify.

1st Mrs E M Warrior & OH MY KATIE CDex UDex WDex (XBreed). Well done Lis, Katie did a great track - just struggled on one corner but found all the articles on the track and then found 4 articles in the square. Also best track trophy Just bits and pieces on the control but a good solid round Well Done and Good Luck in Ticket. 206pts Q.

2nd Miss L Jones & LIVELY CLIVE CDex UDex WDex. (ESS). A lovely track. Clive loves his tracking. Left one article in the square. Heelwork needs tidying up and the agility let you down to-day Well done on your qualification. 199Q.

3rd Mrs T Collier & SORUMOUR JUST FOR A LAUGH AT GLENTTRADA CDex UDex WDex. (GSD) A super dog

who tracked really well. 194.5 Q.

4th Miss K Asterbury & ANGEL IN DISGUISE CDEx UDex WDex. (XBreed) Another nice track and search the Agility stopped this team from qualifying. 187.5 NQ

* * * * *

SCOTTISH WORKING TRIALS SOCIETY OPEN TRIAL

Airth Mains Farm, Airth.
18th - 19th March 2006

STAKE: UD NOSEWORK

Judge: ED BROWN
Steward: Betty Orrin

Thanks to the Scottish Working Trials Society for the invitation to judge UD Nosework.

Many thanks to the Trials Manager Rachel Henderson, the base team; Dave Braithwaite and Betty Galderwood and also the caterers who kept us all happy - Smashing food!

A big Thank you to my tracklayers; Joyce Rae and Jim Jeffery, and my search steward Betty Orrin who were all excellent, great company and kept things running smoothly all day.

Tracking was on stubble with grass coming through. The weather was kind, no rain and slight to no breeze at all. This along with the sportsmanship of the competitors made for an enjoyable day. Good luck to all the competitors in future trials.

1st Miss M. Delaney with BROCKETSFIELD BLACK MAGIC (cross-breed), Bitch. Super track and search square by this team, congratulations on a

very successful weekend's trialling. (NW 141/145) Q.

2nd Mrs J Beaton with TRIALEX NORTHERN LIGHT (GSD) Dog. A strong shepherd that stormed around the track, well done. (NW 133/145) NQ

3rd Mr J. McKay with CONADREW VASKO (GSD) Dog. A well motivated young GSD, tracked well, showing plenty of promise. (NW 120.5/145) NQ.

4th Miss K. Whittemore with DEVILS BECK MUSTANG (Golden Retriever) Dog. Unlucky on the track, good square. A young team with a bright future in trials. NQ.

STAKE: WD NOSEWORK

Judge: BETTY CALDERWELL
Tracklayer: John Hood, Jimmy Scott
Steward: Gwen Matear

My thanks to SWTS for the invitation to judge and to Trials Manager Rachel Henderson who puts so much work into running a trial. Thanks, too, to tracklayers John and Jimmy. Gwen, as ever, was great company.

As always at Skinflats, geese proved a bit of a problem and led to a quick change of land.

1st Heather Patrick with SELDOM-SEEN ZIGGY. (WSD) Worked beautifully on the first half then changed her mind on the cutback. NQ

2nd Carol Ashworth with TWEEDSMILL LOCH TAY (F/CT RETR). Did some good tracking but her enthusiastic gundog nose led her astray. NQ

3rd Liz Roberts with CALLANWAY HARRIS (GSD) Enjoyed his outing with all those different smells. NQ

**ICENI GSD CLUB
OPEN TRIAL**

STAKE: PD

Judge: MOIRA ROGERSON
Tracklayer: Brian Glasgow
Stewards: Heather Patrick
Criminals: Brian Glasgow, Gary Tate & Cub Cuthbert

Thank you to the society for the invitation to judge, to Heather Patrick who steward-ed searches, control and the patrol round. Thank you to Brian Glasgow who laid tracks and was a criminal, and to the other two criminals Gary Tate and Cub Cuthbert - all did an excellent job. A big thank you to Rachael who was Trials Manager, and for her hospitality and to everyone else behind the scenes who helped the trial run smoothly.

There were three entries and we had one qualifier.

1st Mr R. Fruzynski's WSD dog XANDOAS SPLASH CDex., UDex., WDex. A good all round performance. Good luck in ticket. 273 pts.

2nd Mrs C. Wright's GSD bitch Norshep AMBER GAMBLER CDex - TDex 269 pts. Unfortunately went out on the agility. A super bitch, good luck in the future.

3rd Miss J. Miller's WSD dog TRKINDALE ACE CDex - TDex. It wasn't Ricky's day today. Better luck in the future.

25th - 26th March 2006
Tollesbury, Maldon, Essex.

STAKE: WD NOSEWORK

Judge RON JAQUES.
Tracklayer. Brian Martin
Steward Paula Jaques

Thanks to IcenI for the invitation to judge, and to Frances Ball and helpers for running the trial.

We only had three entries and all three ran. Tracking conditions were good slightly windy, and all tracks expertly laid by Brian. Thanks Brian. Thanks also to Paula for laying the squares. Only one dog qualified the nosework - Sandra Lewindon with India, but unfortunately went out on the C/A.

1st John Lambert with JACK. 92 NQ. Lovely dog keep on trying.

2nd Angela Gourd with TARN. 75 NQ.

Best WD Nosework trophy went to Sandra Lewindon with India. Well done Sandra.

* * * * *

SOUTHERN ALSATIAN TRAINING SOCIETY



AN INTRODUCTION TO WORKING TRIALS

with

ANNE BUSSEY

Sunday 28th May 2006

Let Anne lead you through the Working Trials exercises using reward based training methods.

Handlers £25 (places limited)

Spectators £15

SATS members 50% reduction (spectators only)

PD TRAINING COURSE

with

MICK TUSTAIN

Saturday 3rd - Sunday 4th June 2006

Handlers £25 per day (places limited)

Spectators £15.00 per day

SATS members 50% reduction (spectators only)

Camping and Caravans welcome

Both courses to be held at:

Hollybush Farm, Poundhurst Rd, Ruckinge, Nr. Ashford, Kent. TN26 2 PQ

For further information contact:

Mark on 01233 733322

GSD LITTER EXPECTED 05 MAY 2006

Sire TOILERS TIMO AT SARSWAY CDX - TDX (JI)

hip score 2:2 Haemophilia free, colour - gold sable

Dam: MESQUAKIE MORNING STAR (KIPPA)

hip score 7:4 colour - black & gold semi long coat

Kippa comes from good working stock and was home bred, her dam GEFNI VERY VOCAL CDX (FOXY) can be seen.

Puppies will be reared in the house and will be well socialised.

Both parents have excellent temperaments and working ability.
Enquiries now being taken - only permanent loving homes need enquire.

Gill Storr (Dorset) Tel: 01202-533528 (AFTER 6.00 P.M.)

E-MAIL mesquakie@tiscali.co.uk

FOR SALE

PEPNICK G.S.D.'s

SABLE BITCH PUPPIES BORN 26.03.06

Ufo Van Guy's Hof HD 'A' SCH III

SIRE: ZIDANE VAN 'T LEEFDALHOF HD 'A' SCH III

Vaya Van 't Leefdalfhof HD 'A'

Zidane Vom Haus Sevens HD 'A' SCH III

DAM: PEPNICK HOLY GHOST HIPSCORE 5:5 CLEAR ELBOWS

Jensil Inndy at Pepnik Hip Score 2:2 Clear Elbows

(World Ch. Tom Van 't Leefdaalfhof SCHIII IPO3 daughter)

Contact: Mrs. Geraldine Nicholas

Tel. 01291 421004 (after 4.00 p.m.)

WORKING TRIALS MONTHLY

Subscription Rates: 12 Months £40.00:

6 Months £22.50: 3 months £12.00

Advertising Rates -

Black and White: Full Page: £56

Half Page £31 Quarter Page £19

Colour: Full Page: £99.00 Half Page

£55.00 Quarter Page £33.00

All advertising must be pre-paid

W.T. Societies: One half page Black and White Ad per trial held free of charge.

Copy must be received by 5th. monthly for inclusion in the following month's magazine.

WTM PUBLISHING

Hollybush Farm, Poundhurst Road, Ruckinge
Kent, TN26 2PQ

Tel.: +44 (0)1233 733322

email: info@workingtrialsmnthly.co.uk

CONCENN GSD's

Puppies ready to go early June.

Dam: **ROCKSPRAY WALLIS AT CONCENN.**
(Wanda) CDX UDX WDX TD open x 2.

Hips 7-7. Elbows 1

(by Grangeguard Fergal of Druidswood. BH
CDX UDX WDX TDX PD - 6 unbroken
working trials generations - out of imported
German working lines)

Sire: **PEPNICK HARVESTMAN AT THAMESPOL.**
(Blake) Hips:6-5. Elbows 0. Blood normal.
(by Zidane v.h. Sevens. Sch3 IPO3 WUSV
04 - out of a bitch by Tom van't Leeftaalhof
SchH3 IPO3 SV WUSV 99.)

Both parents have great temperaments.

Contact: GAIL on 01686 688920

or e mail: gailconcenn@telco4u.com

SCOTTISH WORKING TRIALS SOCIETY OPEN TRIAL

Inchnabobart, Ballater,

Friday 23rd (If Necessary), Saturday 24th And Sunday 25th June 2006

Judges:	C & A	Lorraine Wilson
	TD Nosework	Caroline Wright
	WD Nosework	Helen Jones
	UD Nosework	Stevie Braithwaite
	CD Stake	Gary Tait

Entry Fees: Tracking Stakes £11.00 (Members) £13.00 (Non Members)
CD Stake £9.00 (Members) £11.00 (Non Members)

ENTRIES MUST BE RECEIVED BY TUESDAY 23RD MAY 2006

Trials Manager: Lorna Cottier 01968 682218

Entries For The Above Trials, Schedules And Information (Please Send Sae) From The
Trials Secretary: Mrs. Lorna Cottier, 5 Hillside Gardens, Dolphinton, West Linton.
Peeblesshire Eh46 7ae Telephone Number 01968 682218 / 07816 485265

**SURREY DOG TRAINING SOCIETY
OPEN TRIAL**

(14th) 15th - 16th July 2006

At Ockley Village Hall, Stane Street, Ockley, Surrey.
Judges: PD Stake Dave Marchant
UD Nosework Allyson Tohme
CD & UD C&A Dorothy Bowen

Entry fees: Tracking Stakes £17.00 (Members £15). CD Stake £10.00
Senior citizens £1.00 reduction.

ENTRIES MUST BE RECEIVED BY: 12TH JUNE 2006

Trials Manager: Stan Ford

Schedules from/entries with fees to Trials Secretary
Christine Brooks, Cobleigh, Brookwood, Surrey. GU24 0EL
(please enclose SAE)

**HAMPSHIRE WORKING TRIAL SOCIETY
CHAMPIONSHIP TRIAL**

On: 21st. to 26th. August 2006

At: The Traveller's Rest, Newtown, Wickham, Hants. PO17 6LL

Judges: T.D. Stake: Paula Harvey
W.D. Stake: Jill Carruthers
U.D. Stake: Jill Carruthers
C.D. Stake: Barry Harvey

Entry Fees: Tracking Stakes £17.00. C.D. Stake £15.00 (£2.00 reduction for members)

ENTRIES MUST BE RECEIVED BY TUESDAY 18th. JULY 2006

W.D. early in week. U.D. end of week. Both stakes: all work on one day.

Schedules from / Entries, with fees, to the Trial Manager
Mrs. Jean Howells 22 Beacon Square, Emsworth, Hants. PO10 7HU. Tel: 01243
372958
(Please enclose S.A.E.)

**WESSEX WORKING TRIAL CLUB
CHAMPIONSHIP TRIAL**

Monday 3rd to Sunday 9th July 2006

At: Aller Farm, Upottery, Devon

Judges: TD stake Tony Lockyer
 UD stake Martine Taylor (all work in one day)
 CD stake Jan Vallack (Friday / Saturday only)

Entry Fees: Tracking Stakes - £15, CD - £12.
(£1.00 reduction for paid-up members)

ENTRIES CLOSE FRIDAY 26TH MAY 2006

Schedules from / Entries with fees (made payable to Wessex WTC) to:
Mr Brian Riste, 126 Henson Park, Chard, TA20 1NJ
(Please enclose a S.A.E.)

**NORTH EAST COUNTIES WORKING TRIALS SOCIETY
OPEN TRIAL**

At: The Village Hall, Satley, Co. Durham.
From: 7th - 9th July, 2006.

Judges: PD stake Lorna Cottier.
 UD stake Betty Orrin.
 CD stake Rachel Henderson.

Trial Manager:
JULIA FINDEISEN. Tel: 07917 718151

Entry Fees: Tracking Stakes £15; CD Stake £10. (Paid-up members £2 reduction)

ENTRIES TO BE RECEIVED BY WEDNESDAY 7TH JUNE, 2006.

Entry forms, fee and S.A.E. to:
Carole Hall, Preston Tilery Farm, Brafferton, Darlington, Co Durham. DL1 3LF
(Any KC approved entry form will be accepted)



ASPADS Working Trials Society

President: Mrs M Welham

Chairman: Mr B Gilbert

Secretary: Mr B Harvey

STAMFORD CHAMPIONSHIP TRIAL PD WD UD CD. ENDING SUNDAY 23RD JULY 2006

PD Patrol Sun, all CD, UD and WD work in one day

PD Graham Reaney
UD Ann Timlin

WD Vana Moody
CD Bill Hardaway

Trials Manager & Entries to: Mrs Jean Morley, 6 Main Street, Upton, Gainsborough, Lincs, DN21 5NU
PLEASE NOTE NEW TRIALS MANAGER
CLOSING DATE: 14TH JUNE 2006

SCARBOROUGH CHAMPIONSHIP TRIAL TD WD UD CD. ENDING SUNDAY 6TH AUGUST 2006

PD PATROL SUN, ALL CD, UD AND WD WORK IN ONE DAY

TD Jill Carruthers
UD Dave Stewart

WD Jenny Holt
CD Tracy Park

Trials Manager & Entries to: Mr Barry Gilbert, Lindum, Horsegate Field Road, Goxhill, North
Lincolnshire, DN19 7NN
CLOSING DATE: 28TH JUNE 2006

ABERFORD OPEN TRIAL TD WD UD CD. ENDING SUNDAY 24TH SEPTEMBER 2006

PD PATROL SUN, ALL CD, UD AND WD WORK IN ONE DAY

TD Nelson Smith
UD Glenys Page

WD Jacqui Barron
CD & C/A Dave Todd

Trials Manager & Entries to: Mr Roy Williams, 42 Industrial Street, Horbury, Wakefield, West Yorks,
WF4 5EG
CLOSING DATE: 16TH AUGUST 2006

SCHEDULES & INFORMATION

Trials Manager or Trials & Membership Secretary
Judy Meekings, 189 Guildford Road, Lightwater, Surrey GU18 5RB. Tel: 01276 475225
(S.A.E. Please)

email: judymeekings@yahoo.co.uk

Entry Fees	Tracking Stakes	Members £15.00	Non Members £17.00
	C.D Stake	Members £12.00	Non Members £14.00

SPECIALISTS IN:-

- PROTECTION EQUIPMENT
- NOSEWORK
- AGILITY EQUIPMENT
- COLLARS AND LEADS
- TOYS AND DUMBELLS
- GROOMING / KENNELS / CAGES
- DOG HANDLER EQUIPMENT
- BLANK FIRING GUNS
- BOOKS AND VIDEOS



Call Now
for a 2006
catalogue

New Product
Tuff Sox!!!



Main UK agent
for Schweikert and
Inntotek equipment.

The UK's main
supplier of
equipment for the
professional Dog.



JOHN HUMPHRIS LTD
Serving You...

Shop at www.john-humphris.com

Imperial Centre, 41 Gatwick Road, Crawley, RH10 9LD

Telephone: 0870 4050550 • Fax: 0870 4050551

Email: sales@john-humphris.com