

December 2013

Volume 28 No 9

# WTM

WORKING TRIALS MONTHLY



WESSEX WORKING TRIALS SOCIETY  
OPEN TRIAL QUALIFIERS

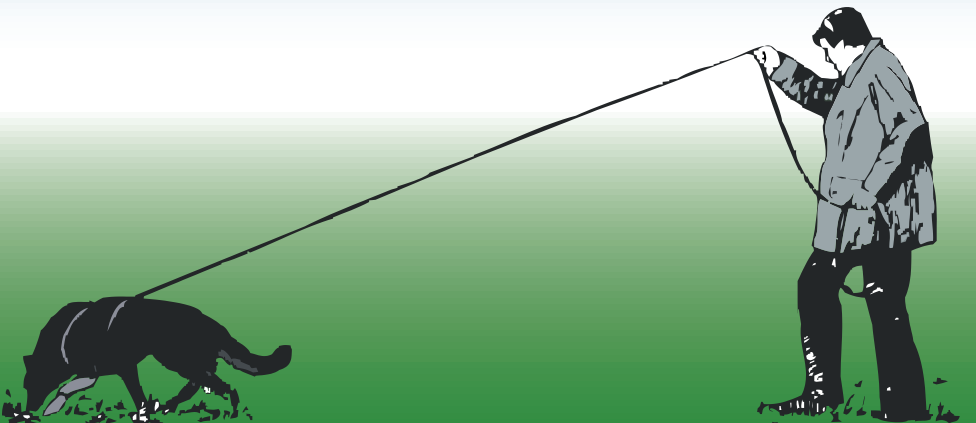

THE ONLY MAGAZINE FOR THE TRIALS ENTHUSIAST

# WTM PUBLISHING

Green Farm  
Fair Oak, Eccleshall  
Staffordshire. ST21 6NT

Tel.: +44 (0)1630 620292

Editor Mark Skillin: mark@workingtrialsmoonthly.co.uk  
Assistant Editor Anne Bussey MSc: anne@workingtrialsmoonthly.co.uk  
Content co-ordinator Judy Meekings: judy@workingtrialsmoonthly.co.uk

Please send Trial reports to:- reports@workingtrialsmoonthly.co.uk  
Please send advertisements to:- adverts@workingtrialsmoonthly.co.uk

## SUBSCRIPTION RATES

U.K.

12 Months	£60.00
6 Months	£35.00

Overseas:

12 Months	£70.00
6 Months	£40.00

## Advertising Rates

Black and White:	Full Page:	£60
	Half Page	£34
	Quarter Page	£23

Colour:	Full Page:	£99.00
---------	------------	--------

All advertising includes VAT and must be pre-paid.

Copy must be received by 5th. monthly for inclusion in the following month's magazine.

<http://www.workingtrialsmoonthly.co.uk>

# WWTM

WORKING TRIALS MONTHLY

## CONTENTS

- Page 3 Editorial  
Page 4 Entries Closing  
Page 4 Readers Letters  
Page 4 Club Focus  
Page 5 2013 Kennel Club Championships  
Page 10 Book Review  
Page 11 Training for Trials  
Page 18 2014 Trials Calendar

### TRIAL REPORTS

- 14 Hampshire WTS CH  
15 Yorkshire WTS OP  
15 North East Counties WTS CH  
16 SATS OP  
21 ASPADS OP  
22 Poole & DDTS CH  
26 EAWTTS OP  
29 Avon WTTS OP

*Front Cover photo:*

*Avon Working Trials Training Society qualifiers at Wessex June 2013 - Meg O'Kelly with Stardell Naos (Border Collie) UDEX, Ann Ketteringham with Paddydepaws at Coalway (X-Breed) UDEX and Jan Baker with Merryway Pebble Of Jaby (Golden Retriever) WDEX*

The opinions expressed within this magazine are not necessarily those of the Editorial staff. Written permission must be obtained for any item to be reproduced whether in newsletters or on the Internet.

©

## EDITORIAL

There have been three championship trials this month; congratulations go to Barry Gilbert with Glenalpine Cosworth for winning the ticket at North East Counties Tow Law TD trial with Paul Adams judging. Next was ICENI's TD trial at Tollesbury with judge Sue Jones' winning team being Tony Lockyer with WTCH Lawinick Come N Get It At Hartshill. And lastly, Stevie Boyall with Vanquish Ultimate Edition took top honours under judge John Gray at ASPADS Dundee TD trial. Well done to you all and good luck at next years KCC's.

We have managed to include the 2014 trials calendar in this month's issue. It is as accurate as possible but a few societies haven't yet finalised all of their details, we believe the dates are all correct but there may be a few change to the stakes held. If these are significant we will reprint it at a later date otherwise any changes will be posted on our website.

Anne and I were chatting the other day and it dawned on us the series of Training Your Dog for Trials is coming to its conclusion with just the heelwork exercise yet to be covered, which leaves the question where do you want us to go next? Anne's next booklet in the "Teach Your Dog To Want To" series "The Sendaway and Redirect" should be ready by the first week in December and will be available from our website.

Christmas is almost upon us and we would like to take this opportunity to wish all of our readers a very happy Christmas.

**MARK SKILLIN**  
EDITOR

## READERS LETTERS

### Thankyou

Thanks to everyone for their good luck cards and messages before the KCCs, and for the many congratulations sent by a variety of media on Isla's win.

My thanks also to Barry and his team at Midland Border Collie Club for a great and well organised weekend.

TONY LOCKYER.

## CLUB FOCUS

They say you learn best when you are enjoying yourself. Well, that proved true for humans and dogs on the recent Working Trials Course organised by Gail Gwesyn-Pryce over three days at Belan, Caersws. Trainer was Moira Rogerson helped by Bill Richardson. A motley crowd of handlers and dogs assembled the first morning, Thursday. All ages, all levels of experience, all (well, many) types of dogs. No breed dominated, dogs ranged from min-

ature pinscher and border terrier through collies, spaniels, whippet, Belgian Shepherds, boxer cross, labrador and German Shepherd youngsters making a start on their working trials career, not old enough to jump, but developing their nosework and control skills.

We were lucky – with the weather. Almost too hot at times, suncream in evidence but we were able to keep our dogs cool and fit to work (and there was a swimming pool). We worked in groups, Moira taking the larger group, people new to working trials or who wished to work on basic WT skills. Bill's group was smaller but 'mixed ability' ranging from the fairly new, ready or almost ready to compete, to experienced handlers looking for a chance to improve, bringing on a new dog or taking the opportunity to enjoy a few days working with their dog and learning along the way.

There was a wealth of experience to draw on, our trainers were patient, able to adapt their training to the needs of the individual dog and handler. Sometimes it was just finding the key – the key to help the less than confident dogs tackle the scale or the key which enabled the dog new to search

## DON'T FORGET . . . . ENTRIES CLOSING

### December

28th	Avon WTTS (Keevil, ends 26th January)	OP	UD	Special	WD
30th	East Anglia WTS (Kings Lynn, ends 19th January)	CH	CD	UD	PD
30th	Midlands Border Collie Club (Old Darby, ends 2nd February)	CH	CD	UD	TD

**ENTRIES MUST BE RECEIVED BY THESE DATES**

## 2013 KENNEL CLUB WORKING TRIAL CHAMPIONSHIPS

HOSTED BY  
MIDLAND BORDER COLLIE CLUB

### TRIAL MANAGER'S REPORT

or tracking understand what we were asking for and to develop the enthusiasm and confidence to succeed. Sometimes it was studying a handler's technique to find out why they weren't getting the best from their dog. We never felt rushed or too shy to ask or that we were taking up too much of a trainer's time.

And, of course, it wasn't all work. It was fun, we talked, we learned from each other and there was a liberal supply of tea, coffee, cakes and biscuits in Gail's training room. There was a meal out in a local restaurant, a get-together in a pub, the pool for dogs and people. The evening before the course started Gail had invited Trevor Cooper, Doglaw to speak at a local community hall. Some of the course members and people from the area attended this interesting and enlightening talk.

Roll on next year.....

On the Sunday following the course there was an opportunity to enter an open trial (Introductory or CD) organised by the Welsh Kennel Club and judged by Bill Richardson. This was a great confidence booster to people who might be diffident about entering, who might have thought – I couldn't, not yet. It is hoped that those who entered this trial and were able to put in place what they had learned will now feel confident to carry on.

**Veronica Hanson**

The Kennel Club Working Trial Championships were held near Melton Mowbray in Leicestershire, from Thursday 17th October 2013 to Saturday 19th October 2013. The hosting society this year was the Midlands Border Collie Club. The base for the event was Scalford Hall Hotel, which is just a few miles outside of the town, set in rural countryside.

Many thanks to all my army of supporters, helpers, track layers, track watchers, stewards and marshalls. Without you all it would never have happened.

The Tracking and Search elements of the championships were held on Thursday 17th and Friday 18th. The land the dogs worked on is owned by the Friars Wells Estate and permission to use these fields was provided by the Estate Manager, Mr Geoff Johnson. All the tracking plots were very much the same, being on fairly new wheat growth in two adjacent fields. We were lucky that there was no rain on either tracking day, although Thursday was a slightly better day being somewhat brighter.

Fourteen Tracking Dog Stake (TD) dogs and handlers had qualified for the Championships during the previous twelve months and with one dog retired prior to the event thirteen dogs worked over the two days (TD Judge was Mrs Jean Howells). Seven dogs worked on Thursday and six on Friday. At the end of this nose-work group for the Tracking Stake dogs there were seven dogs within qualifying marks going into the final day. Also competing on

Friday in their nose-work group were two qualifying Patrol Dog Stake (PD) dogs and handlers (PD Judge was Mr Eric Roberts). Again, the tracking plots were very much the same being on fairly new wheat growth and again being in adjacent fields. Both these teams were qualifying going into the final day.

Saturday's final day competition was to consist of the Control and Agility sections for the Tracking Dog Stake (TD) teams and both Control and Agility and Patrol for the Patrol Dog Stake (PD) teams. The venue for this event was held at the Defence Animal Centre in Melton Mowbray, by kind permission of the Commanding Officer Lt. Col. Richard Pope. We were able to use their superb outdoor grassed equestrian arena, which had adjacent car parking and excellent spectator viewing areas. The day's proceedings began with the Patrol Dog Stake (PD) Control and Agility, followed by the Tracking Dog Stake (TD) Control and Agility, and then finishing with the Patrol Dog Stake (PD) Patrol round.

The winner of the Tracking Dog Stake (TD) was Mr Tony Lockyer with his German Shepherd bitch WTCh LAWINICK COME 'N' GET IT AT HARTSHILL and the Patrol Dog Stake (PD) winner was Mr Lee Payne with his Border Collie / German Shepherd cross dog WTCh LITTLE ROUGH RHINESTONE.

**BARRIE JAMES**

\* \* \* \* \*

## **TRACKING DOG STAKE**

**Judge: JEAN HOWELLS**

**Track Layers: Andy Magyar and Anne Bedford**

**Search and C/A Steward: Vana Moody**

My thanks to The Kennel Club for inviting me to judge the Kennel Club Championships and to all the societies who voted for me. It has been a great honour and an experience I shall never forget.

My thanks to Midland Border Collie Club for hosting this event. It takes a lot of time and effort to put on the Kennel Club Championships and I would like to thank Barrie, Sue and their team for running the Championships. I would also like to thank you for looking after us so well; I really enjoyed my 4 days with you.

The land had been ploughed and sown 3 weeks before the trial and had 2 - 3 inches of growth. This looked green from a distance but close up was a little bare. Many thanks to the farmers for allowing use to use their land. I would also like to thank the Defence Animal Centre for the wonderful control field, which was brilliant for competitors and spectators.

The weather was very kind to us and all our work was done in the dry; it only rained at night or after we had finished working.

I set an uncomplicated track pattern with reasonable sized articles, as the land could prove to be difficult and unfortunately I did lose 6 competitors on the nosework. Two of these were hard luck stories, as they both did good tracks but only found one article. Thanks to Andy and Anne for laying all the tracks between them exactly as I had asked for them to be laid, and to Andy for laying the runoff tracks.

Many thanks to Vana for laying all the squares and stewarding the control and agility, as well as getting me from A to B

and being a general dogsbody. The squares were very well done - Vana only had to find one article.

I set a straightforward control round. I started off with the speak at heel, followed by a second speak with the dog by the handler's side. This was followed by heelwork finishing at the sendaway. The sendaway consisted of a diagonal outrun of 160 yds and a left redirect down a hedge of 180 yds.

I unfortunately lost some competitors after the control round, but only one dog failed to get enough marks on the jumps, so I ended the control with four qualifiers overall.

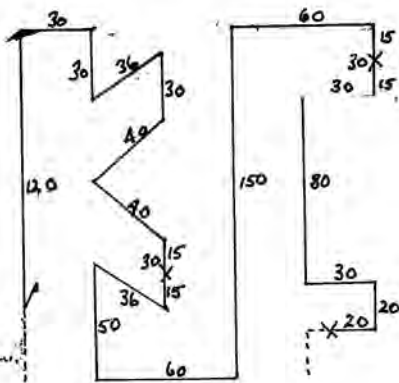

Thanks to all the base staff especially Wendy for doing all the scores. Thanks to Arthur for looking after my dogs for three days. Last, but not least, thanks to all the competitors, who had already proved their worth by being at the Kennel Club Championships.

**1st Tony Lockyer with WTCh LAWINICK COME'N'GET IT AT HARTSHILL,**



GSD, 14/10/2007, winning the Kennel Club Championships 2013, 206 / 220, Q TDEx. A well-deserved win. A steady track and square followed by a good control round. Isla pulled out all the stops on the sendaway! All your hard work paid off. Very well done, Tony.

**2nd Andy Baker with WTCh SID THE LEMON SQUEEZER,**



Border Collie, 22/08/2006, winning the Reserve Ticket, 203.5 / 220, Q TDEx. A very nice track but the second article was costly. A full mark search square followed by a good control round. Well done, Andy.

**3rd** Diane Ling with WTCh DEBEN LITTLE TOM,



Crossbreed, 01/06/2009, 200.5 / 220, Q TDEx. A good track with 3 articles. Tom certainly had us all entertained while doing the square! Unfortunately it was rather costly. A good control round. Well done, Diane

**4th** Sheila Tannert with WTCh STYPERSON CLEO,



Labrador, 22/12/2007, 190.5 / 220, Q TDEx. A good track but leaving an article was costly. A good square followed by a good control round, but knocking the clear jump down was also costly. Well done, Sheila.

I am only sorry you didn't all qualify. To those that did qualify, very well done, and to all of you the very best of luck for the future. Good luck to Tony Lockyer and

Paul Morling and the Wessex team for the 2014 Kennel Club Championships.

\* \* \* \* \*

## PATROL DOG STAKE

**Judge: ERIC ROBERTS**

**Tracklayer: Malcolm Snowden**

**Steward: Danny Roberts**

**Patrol Helpers: Malcolm Snowden (hidden person), Danny Roberts (test of courage), Tom Davies (chase criminal) and Vic Snook (recall criminal).**

My thanks to the Kennel Club for sanctioning this appointment and to the Midland Border Collie Club for accepting me as the judge for this prestigious event. Congratulations to the MBCC for organising and running such a successful Championships.

Only three teams qualified for the event this year, Lee Payne with his dog Diesel and Dave Olley with two dogs, namely Ray and Nell. However Dave decided to retire Nell before the event. I found the standard achieved and the quality of work from both teams very impressive.

Judging started on Friday with the nosework phase. The area for tracking was perfect, with both teams having identical fields. The first team to take part was Lee with his dog Diesel, showing excellent tracking ability and recovering both articles; a full point search gave them a total of 111 points for the nosework section. Dave with Ray followed and again showed an excellent standard of tracking ability, but unfortunately ran out of time for the fourth article to be recovered from the search square, giving them a total of 104 points



for the nosework section.

The Control and Agility started early on Saturday morning, with both teams showing excellent control throughout, with Lee and Diesel having a clear round and Dave and Ray having just half a point deducted in heelwork. In agility it was Dave and Ray with a clear round with Lee and Diesel incurring a two point penalty on the clear jump.

The Patrol phase took place after a lunch break and here I would like to congratulate the four helpers (loosely referred to as criminals), as it is they who make the test a success.

Patrol work started with quartering the area for a hidden injured person. Dave and Ray were first on followed by Lee and Diesel, both dogs showing excellent searching ability, with Ray demonstrating a little more diligence in his work and responding immediately to commands. Locating and indicating the injured person was without fault by both dogs and showed good control during the physical help given by his handler in escorting the injured person. The test of courage came next, with an aggressive assailant refusing to conform to the handler's request. Ray was released to show good speed and true pronounced courage, with Diesel having to readjust before the bite but still taking the pressure from the criminal and stopping the assault. The chase and detention of the next criminal came next, with both dogs doing an excellent job and achieving maximum points. Diesel also gained maximum points in the recall test with Ray having an extra whistle to effect the recall. The total result in the Patrol phase was Dave and Ray achieving 143 points out of 150 and Lee with Diesel 140 points. My congratulations to both teams on an excellent performance. Total for the trial:

Lee and Diesel 304 points out of 320 and Dave with Ray 301.5 points. Well done to both teams and my very best wishes.

Many thanks to my tracklayer, Malcolm Snowden, my search steward, Danny Roberts, and my patrol field helpers, Malcolm Snowden (hidden person), Danny Roberts (test of courage), Tom Davies (chase criminal) and Vic Snook (recall criminal).

**1st** Lee Payne with WTCh LITTLE ROUGH RHINESTONE



Crossbreed,, 304. Q

**2nd** Dave Olley with WTCh LITTLE RAYMOND



crossbreed, 301.5, Q

In conclusion, may I once again thank the Society for an excellent weekend and my best wishes to you all.

## BOOK REVIEW

### ENTHUSIASTIC TRACKING: The Step by Step Training Handbook By William (Sil) Sanders

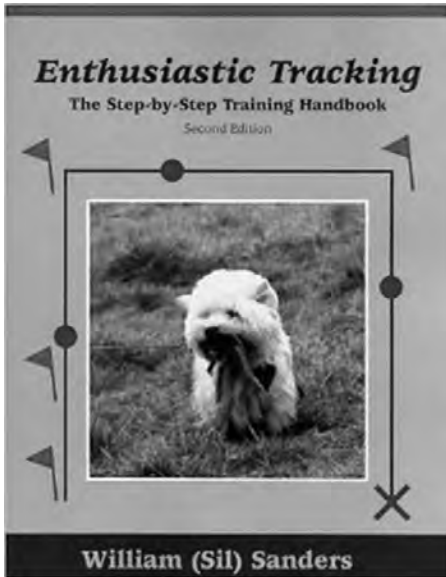

This book was first published in 1991, with the second edition (reviewed here) in 1998 and is divided into “phases” rather than chapters to reflect the progressive programme of training.

Starting with introducing the dog to tracking, it goes on to tackle corners, reading the dog, age, perfecting skills and then goes on to how to prepare for the US TD and TDX tests before moving on to cross-tracks and improving skills.

Each phase has a:

- Purpose
- Strategy
- Schedule

It includes discussion points to be considered by both the tracklayer and the handler as well as an evaluation section.

(The systematic techniques described can of course be followed if the tracklayer and handler are one).

All of the above are accompanied by copious tracking patterns/diagrams which are simple to understand and replicate in training.

I particularly like the pragmatic approach of the writer who make statements such as “ if you cannot get the whole distance laid, just stop rather than mess up the dog by doing something unusual that might confuse the dog”

The author includes detailed tables recording number of tracks, age, length, wind direction, angles and, most importantly, provides problem solving techniques on article indication, backtracking, taking cross-tracks, distractions and poor starts

There is also a page on “unusual” conditions often found at tests (some of which may be familiar to readers)!

This book does what it says on the tin, it provides a step by step explanation of what to do, how to achieve it and why.

Although written by an American I am surprised that this book is not more popular or widely known amongst triallists.

I would thoroughly recommend this book to the novice and believe it has a lot to offer the experienced. It is available via <http://www.positiveanimalsolutions.com/>

**ALLYSON TOHME**

## DIRECTIONAL CONTROL

Many people seem to get worried about teaching the redirect, and I have often heard it said that when training the redirect, the sendaway has fallen apart, resulting in the dog becoming totally confused and not going at all. If you have heard these stories and are frightened to teach it – stress no more! I teach the redirect as a separate exercise: you do not and in my opinion, should not, send the dog away from you, and then ask him to go somewhere else – not until he fully understands all components of each exercise. So many dogs are confused because owners try to do an exercise in its entirety before the dog understands the requirements of each component. I teach three separate exercises:

1. The sendaway – to go in a straight line until told to stop (or reach the boundary).
2. The wait – to remain in either stand, sit, or down at a distance and pay attention to me no matter how far away I happen to be.
3. The redirect – to run to either the left, or right as commanded by me, until told to wait.

The redirect is possibly the easiest of these three exercises to teach, especially if you have already done parts one and two (but if not it does not matter, you could teach this first – just teach the dog to get the reward off the pole as at the beginning of sendaway training and commence from there). The sendaway is not a prerequisite. You will of course need the sendaway earlier in competition, so I guess that is why we tend to teach it first.

When teaching the redirect, I look for a straight fence, or hedge which is ideally has defined right angled corners and no trees or bushes overhanging so that my dog can

learn to run along it without having to deviate around obstacles and pull away from the fence: I want him to run along the boundary. I fix my pole loaded with his reward (see WTM July & August 2013) in a corner allowing my dog to see it, and I pull him along the fence some 10 – 15 paces away and release him to run back along the fence to claim his reward, just as we did when training the sendaway. The only difference being he is now running at a right angle to me instead of straight from me. (For our example, I am teaching him to go to my right.)

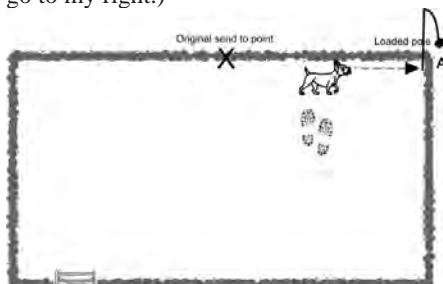

*fig:1*

He already knows the ‘reward-on-the-pole’ routine and he should very quickly get the idea to run to along the fence to claim his reward: remember to use his release word, “Get-it” just before he reaches the pole. He should not look back at you, nor should he have any reason to come away from the fence. He can claim his reward and you will make your way back to the pole and praise him there, then reload the pole ready to start again.

Repeat this exercise, gradually increasing the distance that he has to run to his pole.

If you taught the sendaway first your dog will understand the concept, and should pick this up fairly quickly: Therefore you will be able to increase the distance fairly quickly. If you are training in the same field you taught his original sendaway, build up the distance he runs along the fence so that you can send him from his original sendaway point (without sending him there just taking him along the boundary away from the pole in the corner).

Then send him from beyond his sendaway point, and continue to build up to sending him the entire width of the field. See fig 2 Build his confidence to run in this way without any control (which could cause hesitation to creep in). You want him to run freely and uninhibited, without any confusion in his little brain. There is plenty of time to add control later when he wants to go. Do not dampen his drive and enthusiasm by trying to stop him, or making him wait, not at least until he understands the new direction and wants to go!

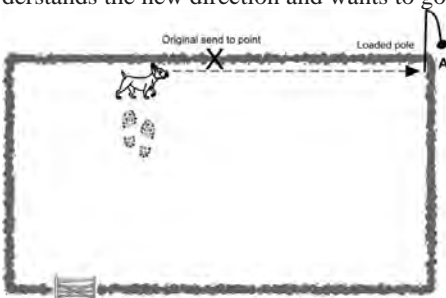

fig:2

*When I am using the same field I used for my base sendaway training, I will want him to run past the original sendaway point without hesitating to arrive at his reward loaded pole in the corner of the field.*

Progress this exercise to teach him to run in the same direction in different locations, each time starting with the loaded pole in a corner of the field. This could be another corner of the same field or a different field – use what you have available to your best advantage (see figs 3 and 3a). At each new location, place your loaded pole in the corner, take him a few paces away, and send him back to it on your command just as before. As he gets more confident, build the distance that he goes. As ever in dog training, it is your job to read your dog. You should not repeat this exercise so much that your dog becomes tired or bored, nor should you expect him to learn the requirements in a set number of repetitions, or days.

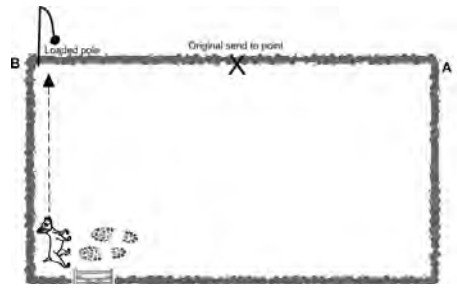

fig:3

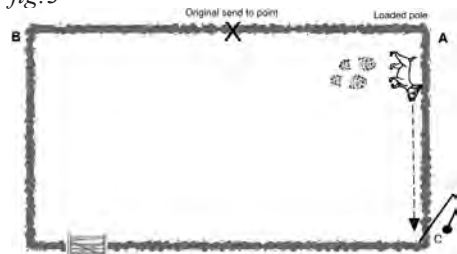

fig:3a

How did you do at school? Were you the whiz kid who always put their hand up first and knew all the right answers? Or were you the one who was always last to understand, the one who did not get it, the one with the lowest marks? Most likely you were somewhere in between. My point being - not all dogs are born equal, no more so than kids. It is your job as your dog's teacher to make the lesson interesting and stimulating, and not to over tax your pupil so that he loses interest, or gives up. Make it fun, make it rewarding. Train your dog to want to do it by keeping the lessons achievable for your dog – not set by some goal on the calendar or fixed number of repetitions. One of the best things about training a dog, I think, is the thrill you get when the dog does well. That wonderful moment when the dog seems to say, 'I know, – I can do it!' your job is to 'listen' to your dog and to help him to succeed.

### Using the Wait

When my dog responds well to my 'go right' command as I release him at the fence, it is time to introduce a 'wait' on the fence, before sending him. If you use the same wait com-

mand that you use to stop him at the end of his sendaway, it will be easy to knit these two exercises together later on. Please note, I am simply teaching the dog to wait at the fence before redirecting him – I do not do a sendaway and then tell him to wait!

I want to build the distance between me and the dog before I direct him, just as there would be a distance after doing a sendaway, except that I tell him to ‘wait’ as I leave him at the fence and I back away (just as we did in our earlier ‘wait’ training WTM October 2013 ) before directing him.

see fig 4

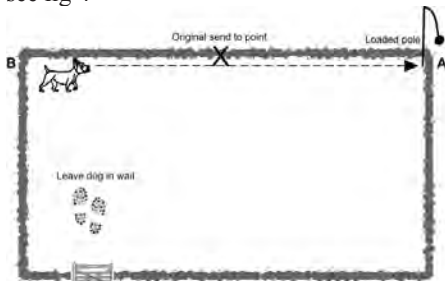

fig:4

So now you can leave him at any point along the boundary and tell him to wait; you can walk any reasonable distance (think trials, think 75 – 150 paces) and he will maintain his position and keep his attention on you. You have captured his attention by being unpredictable, he pays attention because your training is fun and he never knows what you are going to do next – but he is ready!

Remember to reward him for waiting sometimes, or he will lose the inclination to wait: this will mean walking back to him and rewarding him where you left him. Or you might tell him to wait on the boundary, back a few paces away from him and then praise him for waiting and release him with his ‘get-it’ command and pull the reward from your pocket. You could on the other hand, tell him to wait, back off and then send him on to his reward on the far corner of the boundary. The secret, as ever, is to ensure the dog listens and

does what you ask, rather than going self employed.

Training essentials – always have a second, identical reward in your pocket so that you can recall and reward at any time

Enthusiasm is great, but enthusiasm with control is what you want. Do not fall into the pit of correction – instead use your superior brain to orchestrate appropriate rewards. That means think ahead! If your aim is to work on his wait before sending him, allow your dog to think you have loaded his pole in the corner of the field, but secretly pop the reward back into your pocket. Take him along the boundary as usual, and he will be expecting you to send him to your right to get his reward. Instead of sending him, tell him ‘wait’ (he does of course know exactly what that means at this stage). If he does as you ask praise him immediately and then release him to collect the reward which you produce from your pocket. If however he says ‘I don’t think so – my reward is on the pole on the corner,’ just allow him to go. He will not be rewarded because it is not there! You can smugly think to yourself, ‘Ha that will teach you to listen to me!’ There is no need for you to shout at him, or tell him off. Simply allow him to learn the consequences of his behaviour. You should always plan ahead in this way so that he will be rewarded if he obeys your commands - but not if he does his own thing.

**ANNE BUSSEY**

*More next month*

# TRIAL REPORTS

## HAMPSHIRE WORKING TRIALS SOCIETY CHAMPIONSHIP TRIAL

23 - 24 August 2013  
North Boarhunt, Hampshire

**STAKE: CD**

**Judge: ZOE FINLAY**

**Stewards: Odette McInnes and Arthur Jeal**

Thanks to Hampshire Working Trials Society for the appointment to judge the CD stake at this lovely, friendly trial. Thanks to Jean Howells for all the organisation and the fabulous accommodation, the ladies in the kitchen, Jan on the base and last but not least my two super stewards, Odette McInnes and Arthur Jeal. Odette is very new to trials and volunteered (I think that's what they call it) to do my search squares both days, Arthur stewarded the C/A on Friday and Odette took over on the Saturday. Thank you both, you did a great job. Thank you to the competitors for entering under me - you had lovely attitudes to the test and your dogs.

We had fabulous warm weather on the Friday and a few showers on the Saturday, though nowhere near as bad as was forecast. We had 13 entries, 10 ran, with 4 qualifiers overall. The work on the whole was pretty good; most just need to tidy up on a few areas. First and second place handlers finished on the same marks, but as they both competed on the Friday and were not present on the Saturday I awarded Lee and Izzy first place for the better nosework

of the two teams.

**1st** Lee Lampart and HUXTABLE IZZY, BC, 86, Q CDEx. Izzy did a lovely square and retrieve, and the comment on my scoresheet read "perfect" in the heelwork section. Just the sendaway and long jump a little weak. Lovely work, Lee, good luck in the tracking stakes.

**2nd** Stella Richards and GLENALPINE KASHEL, BC, 86, Q CDEx. Very enthusiastic young dog and calm, steady handling by Stella. Cash lost a few marks with his lively heelwork but it was still under control and nice to see such happy heelwork. Again the over-enthusiasm lost the team a few marks on the nosework. Lovely jumps.

**3rd** Hazel Burton and HAZTONS QUEST, BC, 84, Q CDEx. Lovely retrieve and holds; just a shame Quest didn't find that last article. Just a little glitch on the long jump, otherwise nice work overall.

**4th** Vana Moody and GLENALPINE RISA, BC, 81, Q CDEx. Very nice square and retrieve, and settled into the heelwork nicely. Risa lacked confidence on the sendaway, but Vana's calm and experience got her a little closer to the marker. Jumps fine apart from the long.

A brief mention for Club member Rosemary Chase - not qualifying, but putting in a very good performance despite having even worse competition nerves than me (and that's saying something). I really felt for you as I so understand what it is like (though I don't recall almost having my judge in tears). The only thing that let you down was the sit stay. Please keep it up, Rose, you will get your qualification.

# **YORKSHIRE WORKING TRIALS SOCIETY OPEN TRIAL**

7 - 8 September 2013  
Rufforth, York

## **TRIALS MANAGER'S REPORT**

I would like to start by thanking the local farmers for their continued support in providing the land. I would also like to thank the YWTS Committee for their support and help with the running of the trial; their help made the trial both enjoyable and successful.

The trial was held at Rufforth playing fields. There were 10 WD, 14 UD and 5 CD entries. All the teams which competed in CD said they enjoyed the experience; some of them were competing for the first time in Working Trials, which is still popular with new handlers, and I hope they continue enjoying the sport.

The UD and WD nosework was on stubble and quite a number of dogs found it difficult on the day. All the control was held on the playing fields at the base.

A big thank you to the judges, Nigel Hines, WD Nosework, Malc Snowden, UD Nosework, and Joan Snowden, CD and C/A UD/WD, and their stewards for setting excellent tests and creating such a friendly atmosphere.

I would also like to thank Trials Secretary, Wendy Craven, for booking in and keeping everyone organized. Thanks to Teresa Musgrave, Carol Grant and Stuart Holliday for doing an excellent job catering for the workers and competitors and helping at the base throughout the trial. Thank you to our team of experienced tracklayers:- WD, Richard Musgrave and Jeff Margreaves; UD, Tom Mills and Pete Turner.

Two helpers who were not able to make the

trial this year were Cath and Damian Chadwick. Damian was seriously ill in hospital at the time; we wish Damian all the best and a speedy recovery.

Lastly I would like to thank all the competitors who took time to say how much they enjoyed the trial.

**DAVID CRAVEN**

\* \* \* \* \*

## **NORTH EAST WORKING TRIALS SOCIETY CHAMPIONSHIP TRIAL**

7 September 2013  
Alnwick

**STAKE: WD**

**Judge: JILL CARRUTHERS**  
**Tracklayers: Jimmy Scott and Lorraine Wilson**  
**Search and C/A Scribe: Sharon Dunn**

I would like to thank NECWTS for this judging appointment. Thanks to Jacquie Hall, the trials manager, who had a nightmare with the WD tracking land at 11 o'clock on Friday night, being told that the lovely WD land was going to be ploughed the following day. She managed to find enough land for us but it proved too difficult for the dogs; unfortunately we didn't get a qualifier, which was such a shame for the tracklayers, Lorraine and Jimmy, who had to go off and recover the articles. We were all willing the dogs to get round - a big thank you to you both. Thanks must also go to Sharon, who had 100% success with laying the squares and also scribed the

C/A round - a very efficient lady and super company. Many thanks to the ladies in the kitchen (wonderful goodies), the escorts and helpers - you all helped make this a lovely, enjoyable trial

**1st** HEATHERMARK HAWK, GSP, with Debbie Meade, 163. Harrison worked his socks off and managed to get round the track, with Debbie reading him very well on such hard ground; he produced the best search gaining full marks. Fantastic agility and control, but he failed the down stay, which was tragic after all his effort. Debbie, don't give up with him, he is far too good and will win tickets once he has the down.

**2nd** BANDAITCH DIRTY HARRY, X-Breed, with Julia Findeisen. Harry gave his all trying to find the track for Julz, who handled him brilliantly; knowing when to give up is a fine line but you made the right decision. As ever, he produced a beautiful control and agility round - he is a star, Julz.

**3rd** COWPE CRUSADER, BC, with Emily Arch. Jasper took straight off from the pole. We were thrilled, and he found the next leg, but struggled on the second corner and just could not find the next leg. He worked a very good control round, just had a hiccup on the agility.

**4th** MURPHY MAGNUS LUM-MOX, BC, with Martyn Willcock. Murphy is a very excitable boy; he enjoys the nosework but again it was just too hard. His C/A was quite vocal, which is due to his over exuberance; hope he did well with his PD, which I know is his first love!

The competitors were very good sports accepting the conditions and result - have no fear, it was not due to your dog not being up to the test, it was just the ground conditions being so tough.

Good luck to you all at your future trials

## SOUTHERN ALSATIAN TRAINING SOCIETY OPEN TRIAL

The Village Hall, Stalisfield Green, Kent  
20 – 22 September 2013

### TRIAL MANAGER'S REPORT

This was a completely new venue for SATS and the first trial to be run in Kent for quite some time. A huge thank you to Sharon Carter, who lives in the village and was able to secure the land through her close relationship with the farmers and the community in general. My thanks go to Richard Baker and David Murray for access to the land on their farms, also to Richard and Marianne at the Plough Pub for the use of their paddock for the C/A and the caravan pitches.

We ran three stakes, Introductory, WD and TD. The WD tracking was on stubble and TD on grass; probably the biggest influence on success or failure related to the amount of game around. That said, the gamekeeper, Garry Bell, was most accommodating.

We had the use of the village hall as our base, directly opposite the pub. To say the hall had character would be an understatement, but it worked so well for us, allowing us all to eat together in the evening, which really brought the team together. Whilst on that subject, a huge thank you to Linda, who not only kept everybody fed and watered all day but somehow managed to produce a choice of menu each evening for us all to enjoy. All the additional cakes, quiches etc. that were brought by helpers and competitors are also greatly appreciated.

So many people gave up their time so willingly to help; Sharon Carter, who judged the TD and was an enormous help in es-



tablishing the trial generally; her steward, Jane Wood, and TD tracklayers, Andy and Emma Baker, Stan Ford; Rita Banfather, who judged the Intro and WD, her steward Carole Brooke and WD tracklayers, Steve Banfather and Barry Harvey (yes he came out of retirement for me!). Sylvia Cook held things together for me as base steward and Peter Brooke helped and supported me with just about anything.

The atmosphere throughout the trial was brilliant; the weather was kind and so far the feedback has been positive. Yes, there were the inevitable hiccups but now that the farmers, gamekeeper and local community have a better understanding of what a trial entails, I am sure there will be future trials at this venue.

My thanks to the competitors who entered, particularly not knowing the venue, and for all those that stayed for the presentations on Sunday afternoon - it was great to see so many of you still there and it added something to the occasion.

## **LES ALLEN**

### **STAKES: WD AND INTRO**

**Judge: RITA BANFATHER**

**Tracklayers: Barry Harvey and Steve Banfather**

**Steward: Carole Brooke**

I would like to thank SATS for asking me to judge Intro and WD at their open trial in September. It was a new venue, and what a venue it was! The land owners kindly let us use their land, some stubble and some grass. A big thank you to them - I hope we are welcome back.

The village was so quiet you could walk your dogs around the lanes, as apart from the odd tractor there seemed to be nothing

on the roads. The few locals were so friendly. All that and a great pub!

Les and Linda worked their socks off making sure we had everything we needed and more. Linda produced a cooked meal every night as well as feeding all the helpers and competitors during the day.

My steward for WD and introductory was Carole Brooke. Thank you, Carole, you did a great job of helping the competitors and myself, good company too.

### **INTRODUCTORY STAKE:**

The Introductory Stake was held on Sunday. Seven entered and all 7 competed.

I do enjoy the introductory stake as I like to see new people in our sport. I hope we made them feel relaxed and wanting to do more.

**1st** Chris Brooksby with Chris, RAVENSBROOK CHRIS, BC, 82.5, Q. Lovely round, a dog and handler ready for higher stakes.

**2nd** Lynne Watkins with Szarka, STARSHOT SZARKA WITH SZIKRAS, Hungarian Wire Haired Vizsla, 81, NQ. Lynne handled this young dog so well. I am sure you will both go far.

**3rd** Angelika Wicker with Clive, CHICERRON CAPTAIN DUNWELL, Beauceron, NQ. My first meeting with a Beauceron and what a nice dog Clive is. Get him happy with his down stay and I am sure we will be seeing a lot more of this big fella in trials.

**4th** George Davis with Kaiser, JASROX ARROW, GSD, NQ. Kaiser did a full mark search square and loved it. You both need more experience so please keep going - you will get there, I am sure.

# WORKING TRIALS

## January

19	East Anglian WTS	Terrington St Clement	CH	Intro CD UD PD
26	Avon WTTS	Keevil	OP	UD Special WD

## February

2	Midland Border Collie Club	Melton Mowbray	CH	CD UD TD
9	Welsh Kennel Club	Laleston	CH	Intro CD UD WD TD
9	Leamington	Bretford	OP	CD UD TD
16	NE Counties	Ashington	OP	CD UD WD TD
16	ASPADS	Oxford	CH	CD WD TD
23	NW WTS	Lower Withington	CH	CD UD WD PD Veteran
23	Surrey DTS	Newdigate	OP	Intro WD TD
23	ASPADS	Dundee	OP	CD UD WD TD

## March

2	Yorkshire WTS	Nostell	CH	CD UD WD TD
8	Poole & District DTS	Ringwood	OP	UD WD TD
9	Lincoln	Dunholme	CH	CD UD WD PD
15	SATS	Beachy Head	CH	CD UD WD TD
16	Essex 2000	Danbury	OP	Intro UD WD TD PD
16	SWTS	Gateside, Fife	OP	Intro CD UD
22	Hampshire	North Boarhunt	OP	UD WD TD
23	Iceni	Tollesbury	OP	CD UD WD TD
23	Hucknall	Alfreton	OP	UD WD TD PD
29	BAGSD	Tewkesbury	CH	CD UD WD TD
30	West Herts	Piccotts End	OP	Intro UD WD TD

## April

6	ASPADS	Enfield	CH	CD UD WD TD
6	Yorkshire WTS	West Bretton	OP	CDUD WD TD PD
13	Banbury	Hinton in the Hedges	OP	Intro CD UD TD
13	BAGSD	Flintham	CH	CD WD PD
19	Surrey DTS	Oakwood Hill	CH	CD UD TD
26	Midland Counties GSD	Walesby	OP	CD UD WD PD

## May

11	ASPADS	Scarborough	OP	Intro UD WD TD
18	SWTS	Lauder	CH	Intro CD UD WD PD Vet

## June

22	SWTS	Inchnabobart Ballater	OP	CD UD WD TD
29	Wessex WTS	Uptontery	CH	CD UD WD TD

# S CALENDAR 2014

## July

12	Surrey DTS	Oakwood Hill	CH	Intro CD WD PD
20	NE Counties WTS	Alnwick	OP	CD UD WD PD

## August

3	ASPADS	Scarborough	CH	CD UD WD TD
10	Midland Border Collie Club	Melton Mowbray	OP	CD UD
17	WKC	Laleston	OP	Intro CD UD WD TD
23	Hampshire	TBA	CH	CD UD WD TD
31	BAGSD	Oxspring	OP	UD PD
31	SWTS	Lauder	CH	Intro CD UD WD TD Vet

## September

7	NE Counties WTS	Alnwick	CH	CD UD PD
36	Yorkshire WTS	Rufforth	OP	CD UD WD
21	SATS	Faversham	OP	Intro WD TD
21	ASPADS	Monk Fryston	CH	CD UD WD PD
27	Poole & District DTS	Linwood	CH	CD UD WD TD
28	East Anglian WTS	King's Lynn	OP	Intro CD UD PD

## October

5	Surrey DTS	Oakwood Hill	OP	CD UD PD
5	Avon WTTS	St Briavel's Glos	OP	Intro CD
5	SWTS	Macmerry	OP	CD UD WD TD PD
12	Midland Counties GSDA	Walesby	CH	CD UD WD PD
12	SKC	Muthill	OP	CD UD TD
18	Wessex WTC	KCC	CH	TD PD
26	NE Counties WTS	Satley Tow Law	CH	CD UD WD TD Vet
26	BAGSD	Long Compton	OP	CD UD TD

## November

2	Iceni	Tollesbury	CH	CD UD WD TD
9	ASPADS	Dundee	CH	CD UD WD TD
9	Ranmore DTC	Ockley	OP	UD WD PD
9	Lincoln	Dunholme	OP	CD UD WD TD PD
16	Leamington	Bretford	CH	CD UD TD Vet
16	ASPADS	Tillmouth	OP	Intro CD UD Vet
23	Essex 2000	Danbury	CH	CD UD WD TD
23	NW WTS	Lower Withington	OP	CD UD TD
29	Benfleet	Hockley	OP	Intro CD
30	SKC	Jedburgh	CH	CD WD TD

## December

7	ASPADS	Enfield	OP	UD WD
31	Yorkshire WTS	Skipsea	CH	CD UD WD TD

## **WD STAKE:**

WD was on the Saturday and we started with the control. Tracking was after lunch. Tracklaying for me were Barry Harvey and Steve. Thanks guys, I know you lost some land, finding the farmer moving bales after you had marked out the fields. Tracking was on stubble with big round bales still in the fields. Out of the six only 2 got round their tracks, all the others doing only one and a bit legs.

**1st** Frances Webb with Monty, NORWULF LUIGI, GSD, Q. Although you didn't find the track easy you did it - well done. Very nice square, only losing one mark.

**2nd** Richard Cornwell with Griff, VON KYNA EAGLE, GSD, NQ. Only losing 2 off the track and one off the square was a lovely nosework round. Once you get your sendaway sorted a dog to go far in trials.

**3rd** Tim Cooper with Boko, GLO-RIOUS GLOSTER, X-Breed, NQ. The tracking on stubble proved a problem. A shame as you did a very nice control round.

**4th** Graham Black with Toby, TOBIAS COLLIER, WSD, NQ. Full mark square and jumps, but sadly failed the track.

## **STAKE: TD**

**Judge: SHARON CARTER**

**Tracklayers: Stan Ford (Friday), Andy Baker (all 3 days), Emma Baker (Saturday and Sunday)**

**Search and C/A Steward: Jane Wood (all 3 days)**

20 entries, 17 worked, 6 awarded COM. This is the first year at this venue so it was

a bit of a learning curve for the farmers and SATS. However, from all the feedback so far, competitors and helpers enjoyed their time with us, qualifying or not, which should be what trials are all about. It is a beautiful area to visit.

A huge THANK YOU must go to: the farmers, Richard Baker of Hurst Farm and David Murray of Snode Farm. Richard enlisted the help of the next door farm when it became apparent he could not provide enough grass fields for our needs; Richard and Marianne at The Plough Pub, providing camping, the control field and, of course, the facilities of the pub; the locals, who were interested in what we were all doing and made us all feel welcome, although a little bemused at times; the tracklayers, Stan Ford, Andy and Emma Baker who laid immaculate tracks as I had asked; Jane Wood, who stewarded for me – it was such a help to have an experienced and concise steward who was great company as well; Sylvia Cook as base steward and a welcoming face for the competitors.

Last, but certainly not least, thanks to Les and Linda Allen, who between them ran the trial and provided ALL the food for competitors and helpers during the day and evening.

The tracking was on grass. The articles were: 3" lolly stick, 4" x 1" black sock and a red shotgun cartridge. The square articles were: 6" x .5" strip brown vinyl, 2" x 2" green foam, 1.5" green hosepipe and an aluminium foil pudding dish folded to 3" x 1.5". 8 competitors completed the tracks. The C/A round was kept straightforward, for me to judge and the dogs to enjoy working, as Working Trials are all about the nosework as far as I am concerned. Make the most of 'do you own thing heelwork', but I could hear the extra commands when you were away from me! Without exception, all the dogs had a good crack at the

sendaway and redirection. We had 100% success on the stays.

**1st** Sue Russell and GLENALPINE DANNY, BC, 207, Q. The spectators (cattle) and ourselves were treated to a master class on the tracking field and C/A.

**2nd** Helen Brown and MANPOL SAPPHIRE, GSD, 206, Q. An excellent track by Freya; marks lost on the track were Helen spotting yesterday's track and not believing her dog, but the dog convinced Helen in the end, thank goodness!

**3rd** Penny Bellis and SHILLINGTON JASMINE, X-Breed, 204, Q. This is a serious working dog! Brilliant track (98), search (35) and sendaway. I love the stop command!

**4th** Joyce Tibbetts and VONHAUS-WOLF MAUD, GSD, 196.5, Q. Worked a very steady, accurate track, losing very few marks until the dog cut across a couple of legs, but still qualifying well with full mark square. C/A – full mark speak, heelwork, stay, long and scale jumps, 9 for the Sendaway. Brilliant!

#### **Also gained COM:**

Sally Baker and CLASOLA DASKA, Weimaraner, 195

Judith Owen and BRENTMOOR JAY, BC, 192.5

\* \* \* \* \*

### **ASPADS OPEN TRIAL**

21 - 22 September 2013  
Monk Fryston

#### **TRIALS MANAGER'S REPORT**

I would like to start by thanking the farmers who very kindly found us sufficient land to run the trial. With all the problems they

have had over the past 12 months they did a fabulous job for us. To my base staff of Jan Darby - what would I do without you? The base ran perfectly again; you seem to be getting the hang of it now!!

My judges once again were a pleasure to work with; PD, Dave Olley and his steward Karen Bexon; TD, Dave Craven, with steward Janine Atkinson; WD, Lol Campbell with Richard Musgrave stewarding; UD, Chris Trevor and his steward Tracy-Lee Sinfield; and CD and C/A judge Eric Carpenter with Yvonne Carpenter on Saturday and Glenys Page on Sunday, with Fran Atkin doing a great job as gate steward. Thank you all for doing a fantastic job.

The tracklayers of Alan Bexon and Dave Raybould in PD, Jeff Margreaves, Malc Snowden and Nigel Hines TD, Joan Snowden and June Hines WD, Tom Darby and Brian Page UD - as good a tracklaying team that any trials manager would love to have. Escorts of Tom Mills, John Atkin and Sheila Margreaves - thanks for all your hard work. It takes a lot of pressure off competitors knowing they don't have to find their own track and we didn't have any wasted tracks.

The kitchen staff of Liz Stewart, Doreen Fawbert, Teresa Musgrave and Liz Mills once again kept workers and competitors well fed and were superb.

Many thanks go to CSJ for their sponsorship which was very greatly appreciated and well received.

The weather for both days was great, dry and sunny, which was very lucky given that just before the trial it had rained for long periods and it started again on conclusion of the trial.

Congratulations to all those competitors who qualified. To those who didn't quite make it may I wish you every success in your future trials.

**DAVE STEWART**

## **STAKE: UD NOSEWORK**

**Judge: CHRIS TREVOR**

**Tracklayers: Brian Page and Tom Darby**

**Square Steward: Tracy-Lee Sinfield**

Thanks to ASPADS for the invitation to judge UD nosework at my most local trial. Thanks also to all the helpers, especially Brian, Tom and Tracy-Lee.

Out of 17 entries, 16 teams turned up to compete! Tracking was on stubble with sparse regrowth, with 9 teams qualifying the nosework section. Thanks to all of you for having a go.

**1st** STARDELL MUSCIDA (Kane), BC, handled by Andrew Fox, 193.5, Q. Full point track and square. Well done.

**2nd** ASHLINDT METEOR (Matrix), handled by Lee Payne, 186, Q.

**3rd** GARTONHAUS BORA OF ASHLINDT (Bailey), handled by Manda McLellan.

**4th,** HAUSBAILEY LOKI (Finn), handled by Di Assheton-Bowtle

## **STAKE: PD**

**Judge: DAVE OLLEY**

**Track layers: Alan Bexon and Dave Raybould**

**Search, control and patrol steward: Karen Bexon**

**Criminals: Alan Bexon, Dave Raybould, Bernie Martens and Mike Wilson**

**Scribe: Jenny Olley**

Thank you to ASPADS for the invitation to judge, and to Dave Stewart and his team for a well-run trial. Thanks also to all the PD helpers.

With an entry of 14 we ran over 2 days; 12 teams worked. Each day started with

nosework on stubble fields - most teams did well - then on to C/A followed by the Patrol round.

We took the theme of an Elvis convention for the patrol round - all the criminals were dressed as Elvis impersonators, everything from the GI, to the rocker, through to the white jump suit. We wanted to have a bit of fun, relax the competitors and entertain the crowd without compromising the test.

When the scores were totalled we had 2 qualifiers running off for 1st place, so I set an exercise around the test of courage and attack on handler to produce a winning team that showed control and obedience.

**1st** Vic Snook and Philo, WOOLSHAN INKSPOT, GSD, D, 270.5 Q. Well done Vic, good overall performance; good luck in ticket.

**2nd** Tom Davis and Ruby, JOTUNHEIM ALMA, Malinois, B, 270.5 Q. A very close run thing, well done Tom.

**3rd** Dave Waite and Rula, EYLAUERHOF RULA, Rott, B, NQ

**4th** Andy Laws and Frankie, LAWS LITTLE FRANKIE, X-Breed, B, NQ

\* \* \* \* \*

## **POOLE & DDTS CHAMPIONSHIP TRIAL**

23 – 28 September 2013  
Redshoot Inn, Linwood

## **STAKE: CD**

**Judge: LES ALLEN**

**Steward: Brenda Nevard**

I would like to thank Poole DTS, and in particular Melvin and Mary Drewitt, for

the invitation to judge the above stake and for running such a relaxed, yet efficient trial. A very special thank you to my steward, Brenda Nevard, who did a superb job, put everyone at ease and was great company. Thanks also to Mark Deacon of Toms Farm for allowing us to use his land for the control field.

Special thanks to Mary Drewitt, who mucks in to help with just about anything, and also heads up the superb team in the kitchen, too many to name individually, keeping both the helpers and the competitors fed and watered. They also provided meals at the end of each day - they all work so well as a team, many thanks.

We had 11 entries and 8 ran, with quite a mix of breeds which was good to see. Great dogs, all of which have the potential to do well in the future as the newer handlers gain confidence and experience. I couldn't have wished for a nicer group of competitors.

**1st** GLENALPINE TOSCA, BC, handled by Lorna East, 87, Q CDEx. A very calm little dog until she enters the square - three articles very cleanly out in 47 seconds. I know the jumps have been a challenge but she did enough today. Well done on qualifying CDEx.

**2nd** TARNEDGE ACT OF FAITH, Lab, handled by Angela Fields, 84.5, Q CDEx. Another very clean and efficient square, with full mark jumps; heelwork cost you dearly on the day but then there is always something to focus on. Well done on qualifying CDEx.

**3rd** TRACELYN NICOLE OF BRUSHBOW, GSD, handled by Lynn Harrison, 73.5, Q CD. Very frustrating for Lynn; generally a good round, with a few areas to tidy up but let down on the sendaway, which proved really costly. Did a perfect one after the test was completed

- I guess you are going out to buy some orange poles!

**4th** AMBERSLADE MARGARITA, ASD, handled by Wendy Donaldson, 88.5, NQ. This was the first ever trial for "Bumble", who did a very strong and clean round, right the way through to the jumps; unfortunately needed a second attempt on the long and failed the return over the scale. Wendy finished on 88.5 points but unfortunately the jumps cost a qualification.

One special mention for Jade Lindsey and her young GSD bitch, Mercy. This was their first trial and despite being extremely nervous Jade held it together to do a great round, with a clean set of jumps and overall tight control, but unfortunately failed the down stay at 9 minutes, missing out the control qualification by 1 point. That said, both dog and handler have so much potential for the future.

I hope you all enjoyed yourselves; it was a pleasure to watch you and your dogs. Good luck for the future.

## **STAKES: UD AND WD**

**Judge: RAY LEA**

**Tracklayers: Len Newman and Gavin Thomson**

**Stewards: UD, Val Thomson; WD, Janet Parker**

Many thanks to Melvin and Mary Drewitt and the committee of Poole and DDTS for the invitation to judge the UD and the WD stakes at their recent championship trial. Thanks also to Len and Gavin for tracklaying both stakes - not easy on the heather but they laid all tracks perfectly; to Val for stewarding the search and C/A for UD and to Janet for doing the same for the UD and

for your lovely company - thank you so much. To the catering ladies, thanks for all your hard work cooking for all the competitors throughout the week - not an easy task from a caravan, - and to everyone who cooked the evening meals. What a brilliant job you all did - fantastic. To all at the trial who made me most welcome - you were all great company, I had a wonderful time. Special thanks must go to Janet and Gerry Parker for looking after me and my dogs in their lovely home and taking us on long walks before breakfast. To June Coutts - thank you for the use of your jumps and land for the control.

Well, it's the first time I've been in this area and what a wonderful place to run a trial; horses, cattle, donkeys, pigs, deer all there but with very little interference to the tracking. Tracking was on heather of varying length. The weather was very kind to us, damp in the morning sunny in the afternoon. WD was run on Tuesday and Wednesday and UD followed on Thursday and Friday, using the same ground. The early tracks fared better on the long heather; having said that, one from each stake did really well on the later tracks, as the result show.

Thank you again to everyone who took part at this lovely trial.

#### **UD STAKE:**

**1st** Brenda Nevard with I SPYDA SPIDER, WSD, B, 195.5, Q. Well, this result says it all. A very good nosework round, only losing half a point, followed by a very polished control round. Well-deserved win.

**2nd** Sue Main with JAZZ THE JOKER, WSD, D, 175.5, Q. A steady round, well done.

**3rd** Nicky Prescott with WAGGERLAND TWINKLE, WSD, B, 174.5, Q. A

nice round from a nervous Nicky. Well done.

**4th** Gwen Robinson with FRANCILIAM BARNEY, GSD, D, 163, Q. Nice to see someone new. Well done, keep it up.

**5th** Bob Burns with GUN WHARF JACK, Lab, D, 162, Q. Well done, Bob. Shame the horses interfered, but you did it at last.

#### **WD STAKE:**

**1st** Angela Sanders with MR MICKY MARVEL TO SZIKRAS, WSD, D, 174.5, Q. Well done, Angela. Tracked well on the short stuff.

**2nd** Carole Brooke with TADMAR-TON DARK REMY, Lab, D, 167.5, Q. Again on the shorter heather. Well done.

**3rd** Maurice Millington with GLENALPINE JUD, BC, D, 188, NQ. Brilliant nosework, only losing half a mark on the track; shame about the scale.

**4th** Brenda Nevard with REDFOR SPIN, WSD, D, 169.5, NQ. Well done, another good track.

Good luck to you all at future trials

#### **STAKE: TD**

**Judge: JOHN WEST**

**Tracklayers: Lindsey Poole, Rob Bracey-Wright, Pippa Bentham, Melvin Drewitt**

**Steward: Cathy Bracey-Wright**

It was a great thrill for me when I received the invitation to judge the TD at Poole, as it was the first venue, many years ago, when I judged my first Ticket; it really felt like I was going home, especially as there are still a number of helpers who were there then and still with their sense of humour -



my ribs still are tender, Len Newman, bullets supplied by Melvin Drewitt and John Reynolds. My thanks to Mary for keeping us under some sort of control and for all the support that Mary gives Melvin in running a very happy and friendly trial - a good footprint for others to follow.

Mary also heads a team of caterers, Barbara, Sue, Le, Carole, plus anyone else who enters the kitchen. Tea and cakes appear as soon as you sit down and all the superb evening meals for 12+ were catered for. Thank you to you all and apologies to anyone that I have missed.

A big thank you to Cath, who laid all the squares very professionally, never once making a mistake with wind direction or losing an article, even in some areas where the heather was quite deep. Cath also was my steward and scribe in the control round - once again a big thank you for putting up with me all week, my wife said that couldn't have been easy!

What can one say about my tracklayers - fog is a great leveller and to have to walk 2000 yards just to find the path next to the dual carriageway is heroic by anyone's standard. I hear you cry, "Compass", but that also in fog does not tell you where the trees and gorse bushes are; however, with all the problems that confronted them the tracks were superb and accurate, which makes my job easier, so a big thank you to Lindsey, Rob, Pippa and Melvin.

My final thank you goes to Le Newman, not only for running the base but for confirming the phrase, "I didn't recognise you with your clothes on" - you made an old man very happy.

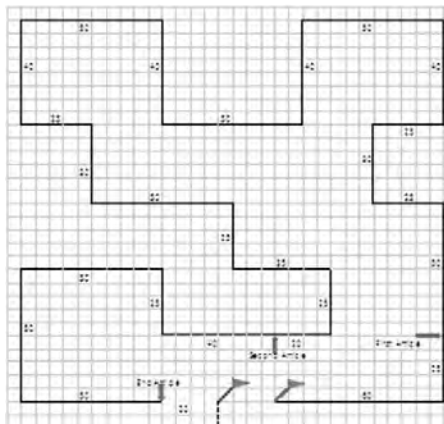

I set the track as to be reasonably straightforward, as I have experienced that the forest can take its toll, which it did, but those that failed must take heart that on another day they can be on the same track on the same piece of land and qualify very well. My first article was a 4 inch pine cone, second a 1.5 inch square of bath mat and finally an 8 inch length of garden cane; only the cone was missed on a number of occasions for those who did the track. The square articles were another 1.5 square of bath mat, a giant Q-tip, a knotted 4 inch garden twine and a Yale key; only 2 competitors gained 4 out of the square but only one with 3 and 4, who was my eventual winner. This was all achieved on the day that the temperature reached 26 degrees.

I would also like to thank the three unsung heroes, namely the non-qualifiers, who allowed me to set and see the control in advance and all were excellent.

**1st** Gary Haim with WTCh WAGGERLAND DILEMMA, WSD, 201, Q. A good track and although Flynn lost 11 marks, getting 3 and 4 proved to be the clinching of this Ticket. With only a few marks lost on the control they were very worthy winners. Good luck at the KCC's.

**2nd** Tony Lockyer with TRIPLE TOP

AT HARTSHILL, CDEx – TDEx, WSD, 191.5, Q. The result could have been a lot closer apart from a small hiccup with the square, however I'm sure that as Bob gains more experience he will be another dog from Tony's camp winning Tickets. Congratulations on the Reserve.

**3rd** Sue Ashby with THE TITAN, CDEx – TDEx, WSD, 188.5, Q. One of my favourite teams around because Titan's work is a joy to watch. However, Sue helped him with the first track article then 3 out of the square; Titan then produced one of the best control rounds of the day. With a little more luck he will be winning.

**4th** John Wykes with KIPCROFT RED KYLE OF TARNFORCE, CDEx – TDEx, BC, 187.5, Q. This team gained 4th by having a sound nosework round despite John's great discomfort with his knees. Kyle showed great tenacity and finished with 3 and 3. With a better control round you will soon be challenging for the top.

#### **Also qualifying TDEx:**

Ann Shepherd with LITTLE MISS LOTTIE, CDEx – TDEx, X-Breed, 187.5. A little better luck in the square and Lottie will be there!

Wendy Magyar with GLENALPINE TED, CDEx – TDEx, BC, 187. Would have been a lot different if Ted had the third track article.

Ruth Payton with CORIES BLAZING STAR AT KALIAZAR, CDEx – TDEx, BC, 185.5. A couple of little mistakes to iron out, but Luna will soon gain more TDEx s.

Joyce Tibbetts with VONHAUSWOLF MAUD, CDEx – WDEx, GSD, 181.5. This was Kari's first TDEx but I'm sure it won't be the last.

Tony Lockyer with WTCh DOUBLE TOP AT HARTSHILL, WSD, 180.5. Not the best of luck on the nosework but Gyp did

his best with the conditions.

June Coutts with CRADBRIDGE BILL, CDEx – WDEx, Lab, 177. With the highest track mark Rubin well deserved his first TDEx.

Sheila Margreaves with SHADOWQUEST KANE, GSD, 177. Coffey was the third dog to be first timers in this stake; it was also deserved.

\* \* \* \* \*

## **EAWTTS OPEN TRIAL**

26 – 29 September 2013  
King's Lynn

### **TRIALS MANAGER'S REPORT**

Thanks to everyone who helps at this trial - and we were blessed with decent weather for a change! Thanks to Keith and Sandra for putting up the judges and letting us use the kennels as a base, Di in the kitchen, the farmers, Paul Morling for judging PD, Diane Ling on her first judging appointment for UD and Margo Brothwell for her first judging appointment for CD and Intro. Thanks also to Brian, who makes sure everyone gets to their tracks on time. Well done to all the competitors, especially those who qualified.

### **KAREN WARNER**

#### **STAKES: INTRO AND CD**

**Judge: MARGO BROTHWELL**

**Steward: Rita Banfather**

Thank you to EAWTTS for inviting me to judge at their open trial and giving me my

first judging appointment. My thanks also to Rita Banfather - excellent steward and very good company. The hospitality at this Trial was excellent and much appreciated.

### **INTRO STAKE**

5 Entries, 3 Ran

Handler nerves and inexperience caused several errors in this stake, but all teams presented some work to be proud of.

**1st** Jackie Pywell with CHELVES-TON KHIZZ WHIZZ, Cocker Spaniel, B, 93, C of M. Very well handled to keep this aptly named little dog focused and controlled. Stunning full point square and very smart control round. Apart from needing a 2nd attempt at the clear, the jumps were very well executed. Congratulations on your well-deserved win.

**2nd** George Davis with JESROX ARROW, GSD, D, NQ. Kaiser is a very enthusiastic dog which George struggles to contain. He manages to keep him working well, but the dog's verbal accompaniment tends to get louder as the round goes on! Mega speed getting the articles from the square! At the end of the day it was just failing the down stay which stopped them qualifying. Good luck for future trials.

**3rd** Esther Preston with ASHLINDT MALACHITE, GSD, B, NQ. Really lovely Shepherd bitch with all elements shaping up very well. Esther was extremely nervous which caused her to throw away a few marks, but this team did the only full point sendaway, which gave them enough marks in the control section, in spite of breaking the down stay. The clear and long jumps were well performed, but nerves dictated and caused a failure on the scale. Good luck for future trials.

### **CD STAKE:**

8 Entries, 4 Ran

Handler nerves also played their part in this stake, but this will hopefully improve as the handlers gain more experience.

**1st** Jill Kevis with MEADOWDALE SPIDER, ESS, D, 91.5, C of M. Nice team, with Ollie showing great attitude. A 2nd attempt on the long jump caused the highest loss of points with just "bits and pieces" to be marked elsewhere - apart from the wonderful full point sendaway. All three articles retrieved from the square. Congratulations on your well-deserved win.

**2nd** Barbara Wesley with BORDER-TRIX ENTREPRENEY, BC, D, NQ. Oscar gave a creditable performance in the control round; all the elements are there, just needs a bit more tidying up. Ran out of time before finding the third article in the square. The jumps were his downfall today. Good luck for future trials.

**3rd** Juliet Maskell with KAMARDA JULIET'S DREAM, BC, B, NQ. A creditable control round; again, all the elements are there, just needing a bit of tidying up, but this little dog also did an excellent full point sendaway and brought all three articles from the square. Sadly Dream decided to lie down in the sit stay and had a "must scratch" itch in the down stay! Good luck for future trials.

**4th** Carol Robertson with WICON-MAGIG DAZZLE, ESS, B, NQ. Fern was very active in the square, but only managed to produce one article. The sendaway was a bit expensive, but the rest of her control round was very creditable. Good luck for future trials.

## **STAKE: UD**

**Judge: DIANE LING**

**Tracklayers: Steve Banfather and Emma Baker**

**Search Square Steward and C/A Steward: Andy Baker**

Many thanks to Karen and Paul for the invitation to judge at this very friendly trial and for entrusting their entries to me on my first judging appointment! I was looked after so well from start to finish - nothing was too much trouble! Many thanks to Sandra for her hospitality and the comfy bed. Thanks must also go to Diane in the kitchen for the lovely food and looking after us so well. It was just all so much fun!

Thanks also go to Steve, Emma and Andy; with such an experienced team behind me, how could I fail? I must say though, they nearly gave me heart failure- when I arrived to judge my first track, they had placed a walk-in pole and a start pole on a field with the roughest plough imaginable and seriously told me that was my first track!! Many thanks for your hard work and cheerful company.

As always the biggest thanks must go to the farmers who generously allowed us to use their land. The weather was unbelievable, warm and sunny with just enough breeze to keep us cool. The conditions were exactly the same for the dogs on both days. We had a mixture of experienced handlers and those new to trials. We saw some good work from promising teams; most mistakes were caused by handler inexperience - get some miles under your belt and you will all do well in the future. Thank you for entering under me and accepting my decisions.

**1st** CHACKMORETON SAFFRON, Golden Retriever, B, handled by Angela Clarke, 187.5, Q. Even though it was

only the second trial for these two, Saffie worked confidently and skilfully throughout the entire test. That tail just didn't stop. Well done, a worthy winner.

**2nd** GARTONHAUS BORA of ASHLINDT, GSD, B, handled by Manda McLellan, 186, Q. Bailey floated around the track and put in a near perfect control/agility round. Bailey will do well with this experienced handler. An added bonus for Manda was beating Lee and Matrix!

**3rd** ASHLINDT METEOR, GSD, D, handled by Lee Payne, 184, Q. Matrix worked the track with careful precision and recovered well after a small hiccup on the 7th leg. Another experienced handler, Lee brought out the best in his young dog through-out the test, focusing and channeling Matrix's huge enthusiasm.

**4th** DAISYHAYAT DOLU, WSD, B, handled by Claire Norton, 182.5, NQ. Daisy-dog wowed us with a near perfect track and square; the best nosework of the stake. She gave a good account of herself in the control round but then failed the jumps. She has a lot of potential Claire, it won't be long before you qualify.

## **STAKE: PD**

**Judge: PAUL MORLING**

**Tracklayers: Andy and Emma Baker**

**PD steward: Karen Warner**

**Tracking and control steward: Hazel Marraner**

**PD helpers: Andy and Emma Baker, Margo Brothwell, Diane Ling**

First I would like to thank all the people who made this trial possible - trials manager Karen, Keith and Sandra for providing the base, Diane for cooking great food, the committee of EAWTS and the farmers who let us use their land, also everyone

who helps in any way to make this trial a success. Thanks to all my helpers for doing such a great job - where would we be without you?

The tracking was on broken plough with last year's rape growing through and was tough going underfoot. 2 out of the 7 contestants failed the nosework section and the control round then knocked out one more. This left me with 4 qualifiers going in to the PD round.

My round started with a basic recall on one man, with the dog recalling about 25 paces from the criminal. As the dog turned back towards the handler after recalling, the helper ran on to a bush and took cover, where I joined him as a criminal for the first part of the quarter. As this was a very basic hide there were no points for a dog that did not speak. On the handler joining the dog they took control of the situation and searched the other hide criminal.

The second part of the quarter then took place, sending the dogs around the field to a wind-break, where three ladies were sitting in chairs behind it; they were then escorted back towards the spectators, during which an attack on handler took place. The chase was next and was followed by the test of courage, which was a criminal going forward shouting towards the dog and handler; he then ran back to join three others, two of whom stood on the sides and threw light plastic balls at the dog as it came in .

**1st** Manda McClellan and LITTLE TIGER, BC x GSD, 293.5, Q. Tiger certainly earned his stripes today. A storming PD round, only losing 5. Well done.

**2nd** Andy Laws and LAWS LITTLE FRANKIE, X-Breed, 276, Q. Glad you decided to make the trip. A well-earned qualification.

**3rd** Rita Banfather and NICOLEE TRUE GRIT OF BANNERSWAY, GSD,

201.5, NQ. Well done first time out; a glitch on your chase cost you your recall marks, so things were far closer than they appear.

**4th** V Snook and LITTLE MICA, X-Breed, 193, NQ. Not your day today, Vic, but I am sure there are good ones to come.

\* \* \* \* \*

## AVON WTTS OPEN TRIAL

5 October 2013  
St Briavels, Glos

### TRIAL MANAGER'S REPORT

Only one very busy day for the trial this year, but with a lovely sunny day and Avon members rallying round to help, we managed to finish on time.

Many thanks to our replacement judge, Pippa Bentham, who stepped in the day before the trial to help us out. Our appointed judge had a very sick dog to look after. I do hope Chaz is recovering, Linda.

So many "thank you's" to say :~ Ann Ketteringham for stewarding both stakes, Barbara Griffith for stewarding the gate all day and keeping the competitors coming; Josie Buttery and June Webb ran the kitchen so efficiently – thank you all. Jan Baker was my "gofer" and kept me up to date with work on the field. I am of course so grateful to Janette Hickson, who was trials secretary, for her efficient paperwork and support before the trial. Meg O'Kelly was my deputy on the day and invaluable help with sorting out the marks and results.

All competitors who entered came on the day, so no cancellations meant a full day.

Thank you for your co-operation with the draw and your donations to the tombola raising funds for the Cinnamon Trust.

**CHRIS YOUNG**

*Continued next month.*

## **WTM BINDERS**

**NOW BACK IN STOCK**

**Keep your WTMs tidy  
with these A5 Binders  
which will hold 12 issues.**

**£8.49 inc P&P**

**Tel: 01630 620292**

### **SURREY DOG TRAINING SOCIETY OPEN WORKING TRIAL**

Ends:23rd February 2014

At; Newdigate Village Hall, Newdigate, Surrey, RH5 5DA

Judges:	TD Nosework	Jane Webb
	WD Nosework	Sandra Lewindon
	Control & Agility	Rita Banfather
	Introductory Stake	Lauren Marlow

Entry Fees: Tracking Stakes - £20.00. Members - £18.

£1.00 reduction for Senior Citizens

Introductory Stake £10.00

Cheques payable to S.D.T.S. Working Trials

**ENTRIES MUST BE RECEIVED BY MONDAY JANUARY 20TH 2014**

Schedules from/Entries with Fees to the Trials Secretary: Mrs. Christine Brooks  
Cobleigh, Brookwood, Surrey. GU24 0EL

Please enclose SAE for report time – Thank You

**MIDLANDS BORDER COLLIE CLUB  
CHAMPIONSHIP WORKING TRIAL**

On: 27th January - 2nd February 2014

at:

The Belvoir Brewery  
Crown Park, Station Road,  
Old Dalby, Leicestershire, LE14 3NQ

Judges:	TD	Anne Thorpe
	UD	Kate Peyton
	CD	Chris Bell

Entry Fees: TD & UD £20.00, CD £16.00

MBCC Members: £2.00 reduction

**ENTRIES MUST BE RECEIVED BY: MONDAY 30TH DECEMBER 2013**

Schedules can be downloaded from [www.workingtrialsworld.co.uk](http://www.workingtrialsworld.co.uk)

or from / and entries with fees to:

Mr B. James, 7 Nursery Lane, Holwell, Melton Mowbray, Leicestershire, LE14 4UF

Tel: 01664 444310

(please enclose an SAE)

**LEAMINGTON DOG TRAINING CLUB  
OPEN WORKING TRIAL**

On: 6th – 9th February 2014

at:

Bretford Village Hall, Bretford, Nr Rugby, Warwickshire, CV23 0JZ

Judges:	TD Nosework	Vana Moody
	UD Nosework	Zoe Finlay
	CD	John Turtill
	C&A	Roger Shrimpton

Entry Fees: TD & UD £19.00, CD £14.00

LDTC WT Section Members Only: £1.00 reduction

**ENTRIES MUST BE RECEIVED BY: MONDAY 6TH JANUARY 2014**

Schedules from / entries with fees to:

Mrs Kate Wykes, 17 Malt Mill Close, Kilsby, Rugby, Warwickshire, CV23 8XN

Tel: 01788 823717

(please enclose an SAE)

**LINCOLNSHIRE GERMAN SHEPHERD DOG AND ABTS  
CHAMPIONSHIP TRIAL**

To be held at The Old School, Dunholme, Lincoln LN2 3SU  
w/e 9th March 2014

Judges:	PD Stake	Graham Reaney
	WD Stake	Glenys Page
	UD Stake	Kath Woolley
	CD Stake	Angela Porter

Entry Fees: PD £20. UD/WD £18.00, (£1 reduction for members)  
CD £15.00, (£1 reduction for members)

**ENTRIES TO BE RECEIVED BY 4TH FEBRUARY 2014**

Schedules from/Entries to : J: Mrs Jenny Henton  
The Laurels, Middle Street, Dunston, Lincoln LN4 2EW tel: 01526 320065  
Please enclose a S.A.E.

**NORTH WEST WORKING TRIALS SOCIETY  
CHAMPIONSHIP TRIAL**

On: Week Ending 24th February 2014  
At: Lower Withington Parish Hall, Near Knutsford SK11 9DU.

Judges:	PD Stake	Mick Tustain
	WD Stake	John Wykes
	UD Stake	Richard Musgrave
	CD Stake	Judy Meekings
	Veterans	Kate Wykes

Entry fees: PD WD UD £18 / CD £13 /Vets £8  
(£1 deduction for members)

**ENTRIES MUST BE RECEIVED BY TUESDAY 15TH JANUARY 2014**

Schedules from/entries to the Trials Secretary Judith Stamp,  
14 Talbot Grove, Bury, Lancs, BL9 6PH  
Tel: 0161 764 2649  
Please enclose an SAE  
Cheques payable to NWWTS



**NORTH EAST COUNTIES WORKING TRIALS SOCIETY  
OPEN TRIAL**

At: Queen Elizabeth Country Park, Woodhorn, Ashington,  
Northumberland. NE63 9AT  
Ends: Sunday 16th February, 2014

Judges	Tracking Dog Nosework	John Gray
	Working Dog Nosework	Cheryl Savage
	Utility Dog Nosework	John Tait
	Companion Dog Stake	Alison Pollard
	TD,WD,UD Control & Agility	Alison Pollard

Trials Manager: Tracey Park: TEL: 01670 362478 / 07707 819568

ENTRY FEES: TD,WD,UD - paid-up members £15, non-members £17  
CD Stake - paid-up members £11, non-members £13

**ENTRIES MUST BE RECEIVED BY WEDNESDAY 15TH JANUARY 2014**

Entry Forms, Fee And S.a.e. To:  
Tracey Park, 29, Devonworth Place, Cowpen Estate, Blyth,

**EAST ANGLIA WTTS  
CHAMPIONSHIP TRIAL**

Ends: Jan 19th 2014  
Waterlow Farm Kennels, Kings Lynn

Judges	PD Stake	Paul Morling
	UD Stake	Belinda Spensley
	CD Stake	Penny Bann
	Introductory	Penny Bann

**SPONSORED BY NEWBURY LODGE BOARDING KENNELS**

Entry Fees PD Stake: £20.00 UD Stake £18 CD and Intro £15  
(members £2.00 discount)

**ENTRIES TO BE RECEIVED BY 30TH DECEMBER 2013**

entries with fees and s a e to Sandra Dearing Waterlow Farm Kennels  
Waterlow Road, Terrington St Clement, Kings Lynn, PE34 4PS  
Tel: 01553 828243 or 827322

**YORKSHIRE WTS  
CHAMPIONSHIP TRIAL**

26 Feb - 2nd March 2014  
Venue TBC

Judges: TD Stake Moria Rogerson  
WD Stake Bill Richardson  
UD Stake Paul Adams  
CD Stake Jenny Olley  
(WD/UD/CD all work in one day)

Entry Fees: TD/PD £20.00 : UD £18.00 : C.D.Stake : £14.00  
(Members may deduct £1 from each entry)

**ENTRIES MUST BE RECEIVED BY WEDNESDAY 29TH JANUARY 2014**

Entry with Fees/SAE to: Trials Manager, Eric Carpenter.  
34, Lowfield Rd. Hemsworth, Pontefract, W.Yorks. WF9 4JN

**AVON WORKING TRIALS TRAINING SOCIETY  
OPEN WORKING TRIAL**

On 24th - 26th January 2014  
at  
Westwood Farm, Keevil, Trowbridge, BA14 6LU

Judges UD Stake Mrs Felicity Veazey  
Copyhold Special WD Pippa Bentham  
Limited numbers to be held only on 24th January  
(This will not count towards any recognised KC Ltd award)

Entry Fees: UD £17.00 (£1.00 reduction for AWTTS Members)  
Copyhold Special WD £10.00

**ENTRIES MUST BE RECIEVED BY 28TH DECEMBER 2013**

Entries with (Fees & SAE) to the Trials Secretary: Ms Anni Martin 11 St Annes Close,  
Baltonsborough, Glastonbury, Somerset, BA6 8RQ



# ASPADS WORKING TRIALS SOCIETY

## CHAMPIONSHIP WORKING TRIAL

At: Oxford, ending on Sunday 16 February 2014

<b>Judges</b>	<b>TD</b>	Norma Ansell
	<b>WD</b>	Vana Moody
	<b>CD</b>	Dave Self

**ENTRIES TO BE RECEIVED BY: WED 15 January 2014**

Entries with entry fee (**Please Enclose SAE**) to:

**Judy Meekings, 189 Guildford Road, Lightwater, Surrey, GU18 5RB  
Tel: 01276 475225**

## OPEN WORKING TRIAL

At: Dundee, ending on Sunday 23 February 2014

<b>Judges</b>	<b>TD</b>	tba
	<b>WD/UD</b>	Dave Stewart
	<b>CD</b>	tba

**ENTRIES TO BE RECEIVED BY: WED 5 February 2014**

Entries with entry fee (**Please Enclose SAE**) to:

**Pam Cuthbert, 180 Macalpine Rd, Dundee, DD3 9HP  
Tel: 01382 818698**

**Entry Fees for 2014 Trials: Tracking Stakes, £21.00 – CD, £16.00 – Veteran £5  
Fully paid up members may deduct £2 per entry**

**For Schedules and/or Membership Information** (*S.A.E. please*)  
**Contact: Hon Sec: Judy Meekings, 189 Guildford Road, Lightwater, GU18 5RB.**

**Tel: 01276 475225 Mob: 07795 086843 Email: [judymeekings@yahoo.co.uk](mailto:judymeekings@yahoo.co.uk)**

UK sole agent  
for Schweikert  
Equipment



Call Now for your new  
Catalogue  
2013

ISO 9001: 2008



Integrated  
Quality  
Standards



REGISTERED FIRM

*Opening Hours:*

*Monday to Friday*

*9am to 5pm*

Imperial Centre  
41 Gatwick Road  
Crawley, RH10 9LD  
Tel: 0845 6532145  
Fax: 0845 6532149

Email: [sales@johnhumphris.com](mailto:sales@johnhumphris.com)

Web: [www.johnhumphris.com](http://www.johnhumphris.com)

# Specialists in

**Protection Equipment**

**Nosework**

**Agility Equipment**

**Leads and Collars**

**Toys and Dumbbells**

**Grooming**

**Kennels and Cages**

**Handler Equipment**

**DVD's, Retrieval & Tug Toys**

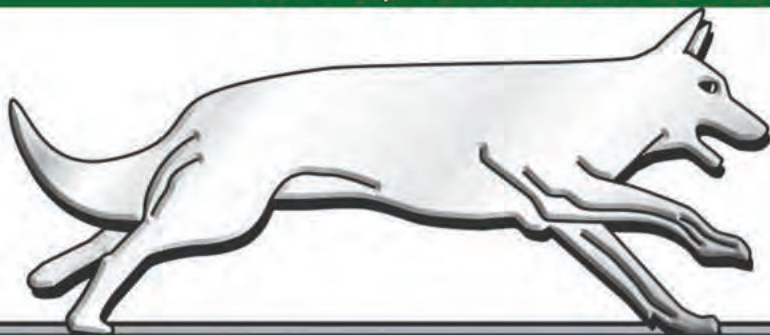

# JOHN HUMPHRIS LTD

*Serving You...*